

New

Bellows suction pads (round) for Packaging

Series VPCN - 2,5 folds

Suction pads in Silicone.
Diameters from 15 to 50 mm with thread size G1/8, G1/4, G3/8 and G1/2, both male and female.

SERIES VPCN BELLOWS SUCTION PADS



- » The material, in compliance with the FDA Standard, allows direct contact with food.
- » The presence of the stabiliser ring avoids that very flexible packagings get sucked into the suction pad.
- » Secure and reliable hold, even at high speeds.
- » Reduced cycle times thanks to high suction rates.

Series VPCN suction pads consist of a nipple and rubber part which are delivered assembled. Both components can be ordered separately as spare parts.

These suction pads are very suitable for the handling of flexible products such as pouches and other flexible, plastic film packaging (like candy bags).

Common applications are:
- Handling of pouches filled with solid, powder-form or liquid substances with low filling
- Quick packaging processes, mainly with a Delta Robot.

GENERAL DATA

Description	robust hard-wearing suction pads consisting of suction pad VPCN and connection nipple
Construction	- nipples and suction pads are supplied already assembled - diameters of 60 mm and more: nipple screwed into supporting plate vulcanised to the pad
Maintenance	it is possible to replace the soft element
Working temperature	SILICONE version: -40°C ÷ +220°C (for short time <30 sec.); -30°C ÷ +180°C (long-term)

TECHNICAL DATA

Mod./Diameter	Suction force (N)*	Int. volume (cm ³)	Internal tube diameter (mm)
VPCN-0150	-	-	-
VPCN-0200	1,70	1,86	-
VPCN-0250	3,0	2,94	-
VPCN-0300	12,8	7,2	9
VPCN-0400	20,4	12,9	9
VPCN-0500	41,0	26,5	12

CODING EXAMPLE

VP	C	N	-	0150	S	-	G1/8	M
-----------	----------	----------	----------	-------------	----------	----------	-------------	----------

VP	SERIES VT = suction pad
C	SHAPE C = round
N	VERSION N = 2,5 folds
0150	DIAMETERS 0150 = 15,0 mm 0200 = 20,0 mm 0250 = 25,0 mm 0300 = 30,0 mm 0400 = 40,0 mm 0500 = 50,0 mm
S	MATERIALS S = silicone
G1/8	THREAD SIZE 1/8 = G1/8 1/4 = G1/4 3/8 = G3/8 1/2 = G1/2
M	THREAD M = male F = female

Suction pad VPCN-0150 to 0500 - male thread

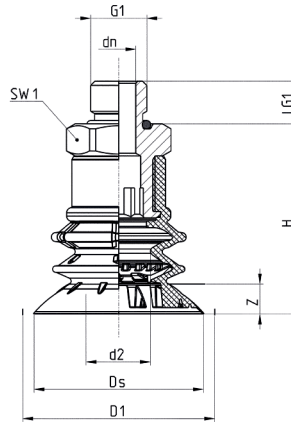

Tolerances for elastomer parts according to DIN ISO 3302-1 E3



Mod.	d2	D1	dn	Ds	G1	H	LG1	SW1	Z	Suction pad	Nipple
VPCN-0150S-1/8M	4,0	17,0	4,1	15,0	G1/8 M	26,3	7,5	14	7,3	VPCN 0150S	NPS-A-1/8-M
VPCN-0200S-1/8M	6,0	22,5	4,1	20,0	G1/8 M	29,4	7,5	14	9,1	VPCN 0200S	NPS-A-1/8-M
VPCN-0250S-1/8M	8,0	28	4,1	25,0	G1/8 M	31,3	7,5	14	9,8	VPCN 0250S	NPS-A-1/8-M
VPCN-0300S-1/8M	7,2	32,0	4,0	30,0	G1/8 M	40	7,5	22	5,0	VPCN-0300S	NPS-C-1/8-M
VPCN-0300S-1/4M	7,2	32,0	8,0	30,0	G1/4 M	40	10,0	22	5,0	VPCN-0300S	NPS-D-1/4-M
VPCN-0300S-3/8M	7,2	32,0	10,3	30,0	G3/8 M	40	10,0	22	5,0	VPCN-0300S	NPS-A-3/8-M
VPCN-0400S-1/8M	15,3	42,0	4,0	39,7	G1/8 M	45	7,5	22	7,0	VPCN-0400S	NPS-C-1/8-M
VPCN-0400S-1/4M	15,3	42,0	8,0	39,7	G1/4 M	45	10,0	22	7,0	VPCN-0400S	NPS-D-1/4-M
VPCN-0400S-3/8M	15,3	42,0	10,3	39,7	G3/8 M	45	10,0	22	7,0	VPCN-0400S	NPS-A-3/8-M
VPCN-0500S-1/8M	21,0	52,0	4,0	49,7	G1/8 M	54	7,5	27	9,0	VPCN-0500S	NPS-D-1/8-M
VPCN-0500S-1/4M	21,0	52,0	8,0	49,7	G1/4 M	54	10,0	27	9,0	VPCN-0500S	NPS-B-1/4-M
VPCN-0500S-1/2M	21,0	52,0	15,0	49,7	G1/2 M	54	14,0	27	9,0	VPCN-0500S	NPS-A-1/2-M
VPCN-0500S-3/8M	21,0	52,0	10,3	49,7	G3/8 M	54	10,0	27	9,0	VPCN-0500S	NPS-A-3/8-M

Suction pad VPCN-0150 to 0500 - female thread

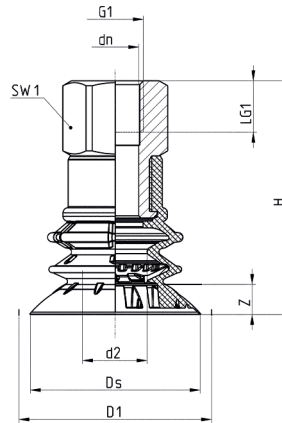

Tolerances for elastomer parts according to DIN ISO 3302-1 E3



Mod.	d2	D1	dn	Ds	G1	H	LG1	SW1	Z	Suction pad	Nipple
VPCN-0150S-1/8F	4,0	17,0	4,1	15,0	G1/8 F	34,3	8,0	14	7,3	VPCN-0150S	NPS-A-1/8-F
VPCN-0200S-1/8F	6,0	22,5	4,1	20,0	G1/8 F	37,4	8,0	14	9,1	VPCN-0200S	NPS-A-1/8-F
VPCN-0250S-1/8F	8,0	28	4,1	25,0	G1/8 F	39,3	8,0	14	9,8	VPCN-0250S	NPS-A-1/8-F
VPCN-0300S-1/8F	7,2	32,0	8,6	30,0	G1/8 F	50	12,0	22,0	5,0	VPCN-0300S	NPS-C-1/8-F
VPCN-0300S-1/4F	7,2	32,0	11,0	30,0	G1/4 F	50	12,0	22,0	5,0	VPCN-0300S	NPS-C-1/4-F
VPCN-0300S-3/8F	7,2	32,0	11,0	30,0	G3/8 F	50	12,0	22,0	5,0	VPCN-0300S	NPS-A-3/8-F
VPCN-0400S-1/8F	15,3	42,0	8,6	39,7	G1/8 F	55	12,0	22,0	7,0	VPCN-0400S	NPS-C-1/8-F
VPCN-0400S-1/4F	15,3	42,0	11,0	39,7	G1/4 F	55	12,0	22,0	7,0	VPCN-0400S	NPS-C-1/4-F
VPCN-0400S-3/8F	15,3	42,0	11,0	39,7	G3/8 F	55	12,0	22,0	7,0	VPCN-0400S	NPS-A-3/8-F