

# INLINE VACUUM FILTERS

## SERIES FVD

For use in vacuum systems with minor to medium levels of dirt.  
Direct mounting on the suction pad.



- Hose connection and blocking nut
- Transparent body with an arrow indicating the flow direction
- Replaceable filter element
- Transparent cartridge to check the filter's conditions

These filters can be mounted directly on the suction pad.  
The filter element can be easily substituted and its conditions can be checked thanks to its transparent wrapping.

### GENERAL DATA

<b>Description</b>	Inline filter
<b>Materials</b>	- body in technopolymer - cloth filter

**INLINE VACUUM FILTERS**  
**SERIES FVD - CODING EXAMPLE**

**CODING EXAMPLE**

<b>FVD</b>	-	<b>4/2</b>	-	<b>50</b>
<b>FVD</b>	SERIES FVD = inline filter			
<b>4/2</b>	CONNECTIONS 4/2 = tube 4 6/4 = tube 6 8/6 = tube 8			
<b>50</b>	FILTER ELEMENT 50 = 50 µm			

VACUUM TECHNOLOGY

**Technical data**

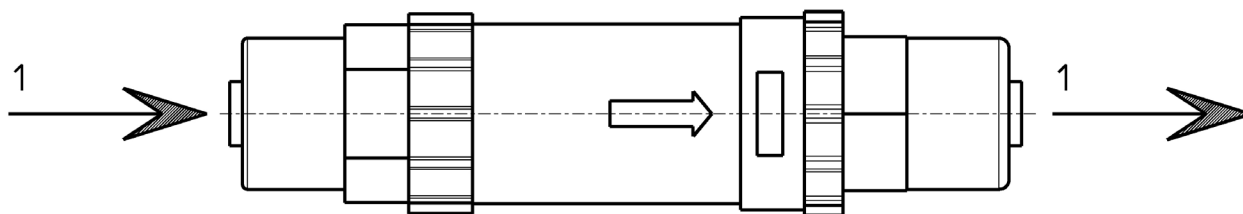

Mod.	Filter element (µm)	Nominal flow (l/min)	Max vacuum (mbar)	Max pressure at 25°C (bar)	Max pressure at 50°C (bar)	Weight (kg)
FVD-4/2-50	50	32	-990	7	5	0,006
FVD-6/4-50	50	32	-990	7	5	0,006
FVD-8/6-50	50	66	-990	7	5	0,010

**5**

## Inline filter

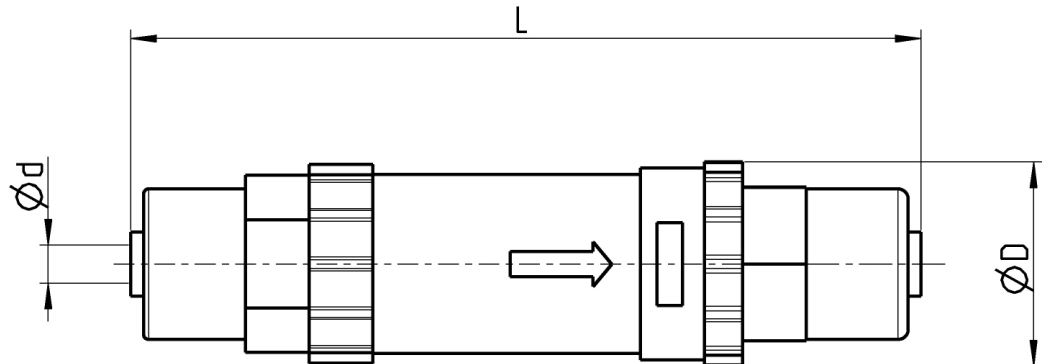

Mod.	d	D	L
FVD-4/2-50	4	17	55
FVD-6/4-50	6	16	61
FVD-8/6-50	8	23	68