

Raccordi accessori Sprint® Serie S2000 in ottone

Filetti dei raccordi: cilindrici (G1/8, G1/4, G3/8, G1/2),
conici (R1/8, R1/4, R3/8, R1/2)



I raccordi accessori Serie S2000 sono caratterizzati da una grande affidabilità dei filetti femmina, sia cilindrici che conici, con superfici non piane.

I modelli Sprint sono dotati di un particolare sistema di tenuta, già alloggiato sul filetto conico, che rende superfluo l'uso di collanti liquidi o del nastro PTFE ottimizzando la fase di montaggio.

Grazie a questo sistema di tenuta è possibile montare e smontare più volte il raccordo senza pregiudicare la tenuta sul filetto.

CARATTERISTICHE GENERALI

Filettature	GAS conico ISO 7 (BSPT) GAS cilindrico ISO 228 (BSP)
Temperatura	-40°C ÷ 120°C (mod. 2541 e 2612: -20°C ÷ 80°C)
Fluido	aria compressa ed altri fluidi a bassa pressione
Materiali	OT nichelato e PTFE
Pressione d'esercizio	80 bar

Raccordi Accessori Sprint®

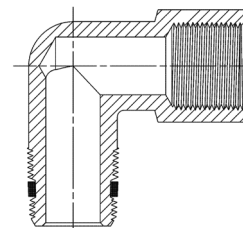

Raccordi Mod. S2500



Niplo Conico Sprint®

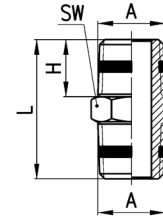

DIMENSIONI					
Mod.	A	H	L	SW	Peso (g)
S2500 1/8	R1/8	7,5	19,5	12	8
S2500 1/4	R1/4	11	27	14	15
S2500 3/8	R3/8	11,5	28	17	21
S2500 1/2	R1/2	14	33,5	22	39

Raccordi Mod. S2530



Niplo Ridotto Conico Sprint®

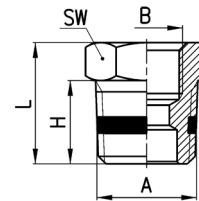

DIMENSIONI						
Mod.	A	B	H	L	SW	Peso (g)
S2530 1/4-1/8	R1/4	G1/8	11	16	14	9
S2530 3/8-1/8	R3/8	G1/8	11,5	16,5	17	16
S2530 1/2-1/8	R1/2	G1/8	14	19,5	22	13
S2530 3/8-1/4	R3/8	G1/4	11,5	16,5	17	33
S2530 1/2-1/4	R1/2	G1/4	14	19,5	22	32
S2530 1/2-3/8	R1/2	G3/8	14	19,5	22	22

Raccordi Mod. S2520



Prolunga Riduzione Maschio Conica Sprint®

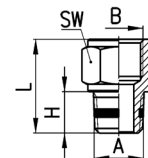

DIMENSIONI						
Mod.	A	B	H	L	SW	Peso (g)
S2520 1/8-1/8	R1/8	G1/8	7,5	17,5	13	11
S2520 1/8-1/4	R1/8	G1/4	7,5	19	17	15
S2520 1/8-3/8	R1/8	G3/8	7,5	20	20	19
S2520 1/4-1/4	R1/4	G1/4	11	22,5	17	17
S2520 1/4-3/8	R1/4	G3/8	11	23,5	20	33
S2520 1/4-1/2	R1/4	G1/2	11	27,5	24	34
S2520 3/8-3/8	R3/8	G3/8	11,5	24	20	36
S2520 3/8-1/2	R3/8	G1/2	11,5	28	24	56
S2520 1/2-1/2	R1/2	G1/2	14	30,5	24	41

Raccordi Mod. S2510



Riduzione Conica Sprint®

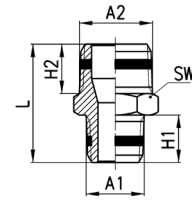

DIMENSIONI							
Mod.	A1	A2	H1	H2	L	SW	Peso (g)
S2510 1/8-1/4	R1/8	R1/4	7,5	11	23,5	14	14
S2510 1/8-3/8	R1/8	R3/8	7,5	11,5	24	17	22
S2510 1/4-3/8	R1/4	R3/8	11	11,5	27,5	17	19
S2510 1/4-1/2	R1/4	R1/2	11	14	30,5	22	33
S2510 3/8-1/2	R3/8	R1/2	11,5	14	31	22	36

Raccordi Mod. 2541



Niplo Maschio Girevole Cilindrico Sprint®

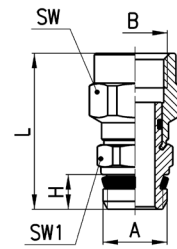

DIMENSIONI							
Mod.	A	B	H	L	SW	SW1	Peso (g)
2541 1/8-1/8	G1/8	G1/8	5,5	28	13	14	17
2541 1/4-1/4	G1/4	G1/4	7	31,5	17	14	26
2541 3/8-3/8	G3/8	G3/8	8	34	20	19	39

Raccordi Mod. S2010



Gomito Maschio Conico Sprint®

-20°C ÷ 80°C

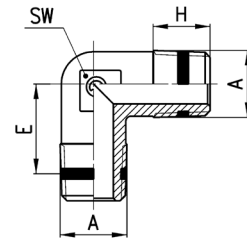

DIMENSIONI					
Mod.	A	E	H	SW	Peso (g)
S2010 1/8	R1/8	11,5	7,5	9	9
S2010 1/4	R1/4	13,5	11	12	17
S2010 3/8	R3/8	15,5	11,5	14	25
S2010 1/2	R1/2	16	14	16	47

Raccordi Mod. S2020



Gomito Femmina Maschio Sprint®

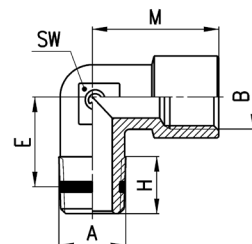

DIMENSIONI							
Mod.	A	B	E	H	M	SW	Peso (g)
S2020 1/8-1/8	R1/8	G1/8	11,5	8,5	19	11	16
S2020 1/4-1/4	R1/4	G1/4	15	11	23	13	27
S2020 3/8-3/8	R3/8	G3/8	15	11,5	25	15	33
S2020 1/2-1/2	R1/2	G1/2	17,5	14	31,5	20	62

Raccordi Mod. S2050

T.M.M.F. Sprint®

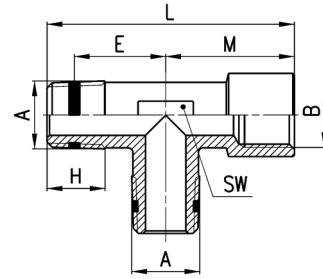

DIMENSIONI								
Mod.	A	B	E	H	L	M	SW	Peso (g)
S2050 1/8-1/8	R1/8	G1/8	11,5	8,5	37	19	12	14
S2050 1/4-1/4	R1/4	G1/4	15	11	46	23	13	44
S2050 3/8-3/8	R3/8	G3/8	15	11,5	48,5	25	16	59
S2050 1/2-1/2	R1/2	G1/2	17,5	14	60,5	31,5	20	81

Raccordi Mod. S2060

T.F.M.F. Sprint®

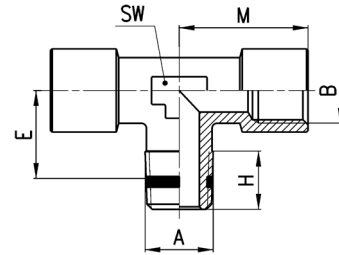

DIMENSIONI							
Mod.	A	B	E	H	M	SW	Peso (g)
S2060 1/8-1/8	R1/8	G1/8	11,5	8,5	19	12	31
S2060 1/4-1/4	R1/4	G1/4	15	11	23	13	38
S2060 3/8-3/8	R3/8	G3/8	15	11,5	25	16	51
S2060 1/2-1/2	R1/2	G1/2	17,5	14	31,5	20	88

Raccordi Mod. S2070

T.M.F.F. Sprint®

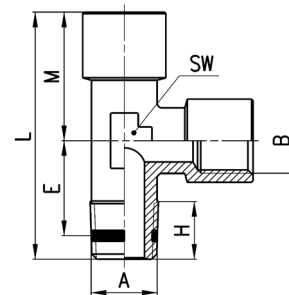

DIMENSIONI								
Mod.	A	B	E	H	L	M	SW	Peso (g)
S2070 1/8-1/8	R1/8	G1/8	11,5	8,5	37	19	12	30
S2070 1/4-1/4	R1/4	G1/4	15	11	46	23	13	36
S2070 3/8-3/8	R3/8	G3/8	15	11,5	48,5	25	16	51
S2070 1/2-1/2	R1/2	G1/2	17,5	14	60,5	31,5	20	89

Raccordi Mod. S2080

T Maschio Sprint®

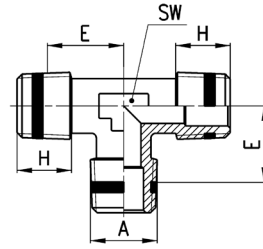

DIMENSIONI					
Mod.	A	E	H	SW	Peso (g)
S2080 1/8	R1/8	11,5	7,5	9	14
S2080 1/4	R1/4	13,5	11	12	31
S2080 3/8	R3/8	15,5	11,5	14	50
S2080 1/2	R1/2	16	14	16	63

Raccordi Mod. S2090

T.M.F.M. Sprint®

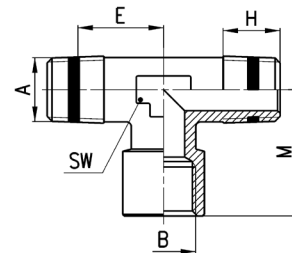

DIMENSIONI							
Mod.	A	B	E	H	M	SW	Peso (g)
S2090 1/8-1/8	R1/8	G1/8	11,5	8,5	19	12	22
S2090 1/4-1/4	R1/4	G1/4	15	11	23	13	16
S2090 3/8-3/8	R3/8	G3/8	15	11,5	25	16	59
S2090 1/2-1/2	R1/2	G1/2	17,5	14	31,5	20	80

Raccordi Mod. 2612

Nuovi modelli



Tappo Maschio Cilindrico

-20°C ÷ 80°C

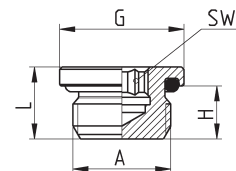

DIMENSIONI						
Mod.	A	G	H	L	SW	Peso (g)
2612 M5	M5	5.8	3.5	5.5	2	1
2612 M7	M7	9.4	5	7	4	2
2612 1/8	G1/8	13.5	6	8.5	4	5
2612 1/4	G1/4	16.4	7	9.5	6	9
2612 3/8	G3/8	20.5	7	10.5	8	17
2612 1/2	G1/2	24.8	8	11.5	12	25

Raccordi Mod. S2610

Tappo Maschio Cilindrico Sprint®

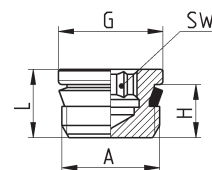

DIMENSIONI						
Mod.	A	G	H	L	SW	Peso (g)
S2610 1/8	G1/8	10.7	5.5	7.5	4	3
S2610 1/4	G1/4	13.8	7	9	6	6
S2610 3/8	G3/8	17.8	8	10	8	12
S2610 1/2	G1/2	21.8	9	11	10	21

Raccordi Mod. S2615



Tappo Maschio a scomparsa
Conico Sprint®

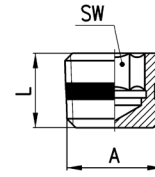

DIMENSIONI				
Mod.	A	L	SW	Peso (g)
S2615 1/8	R1/8	8	5	2
S2615 1/4	R1/4	10	7	6
S2615 3/8	R3/8	10	8	12

RACCORDI ACCESSORI SPRINT SERIE S2000 IN OTTONE