

# Take-off blocks Series MC

**New models**

Ports G1/4 and G1/2  
Modular

- » Compact design
- » Available with or without VNR (no return valve)



The take-off blocks, when equipped with a no return valve, allow the use of non lubricated air and should be inserted between the regulator and the lubricator. If mounted as last element, they should be assembled with terminal flanges.

## GENERAL DATA

<b>Construction</b>	modular, compact
<b>Materials</b>	Zama, aluminium, NBR, technopolymer
<b>Ports</b>	G1/4 G1/2
<b>Weight</b>	kg 0,232 (MC1) kg 0,379 (MC2) kg 0,210 (MC2-B-SH)
<b>Take off ports</b>	G1/4 G1/2
<b>Mounting</b>	in- line or wall mounting (in any position)
<b>Operating temperature</b>	-5°C ÷ 50°C (with the dew point of the fluid lower than 2°C at the min. working temperature)
<b>Finishing</b>	enamelled
<b>Operating pressure</b>	0 ÷ 16 bar
<b>Nominal flow ( 6 bar ΔP 1bar )</b>	MC1-B = 4080 NL/min MC1-B-VNR = 2350 NL/min MC2-B = 8400 NL/min MC2-B-VNR = 5600 NL/min MC2-B-SH = 4080 NL/min
<b>Fluid</b>	Compressed air

**CODING EXAMPLE**

<b>MC</b>	<b>2</b>	<b>-</b>	<b>B</b>	<b>-</b>	<b>VNR</b>
<b>MC</b>	SERIES				
<b>2</b>	SIZE: 1 = G1/4 2 = G1/2				
<b>B</b>	B = TAKE OFF BLOCK				
<b>VNR</b>	VERSION: = standard VNR = with no return valve SH = Space saving take-off blocks (only available for size 2)				

SERIES MC TAKE-OFF BLOCKS

**Spaces saving take off blocks MC2-B-SH**

**New model**



The supply includes:  
1 take-off block  
2 tie rods M5x30  
1 O-ring 3100

BL01 = take-off block

Rods and O-ring not assembled supplied

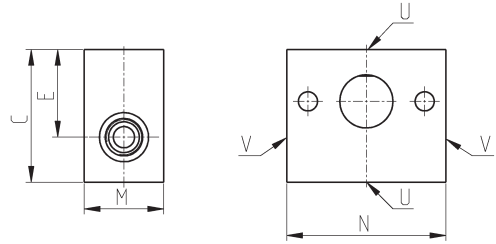

Mod.	C	H		M	N	T	U	V
MC2-B-SH	50	-	33	30	60	-	G1/2	G1/4

**Take off blocks Series MC**



BL01 = take-off block  
BL02 = take-off block with VNR

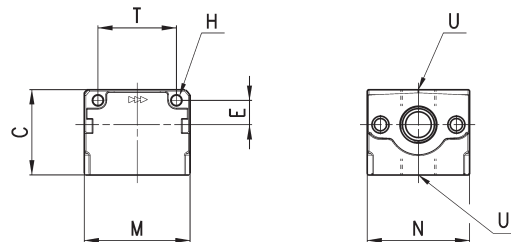
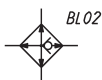

Mod.	C	H	E	M	N	T	U
MC1-B	43	4,5	11	45	45	35	G1/4
MC1-B-VNR	43	4,5	11	45	45	35	G1/4
MC2-B	50	5,5	14	62	60	46	G1/2
MC2-B-VNR	50	5,5	14	62	60	46	G1/2