

Series MC take-off blocks

Ports G1/4 and G1/2
Modular

- » Compact design
- » Available with or without VNR (no return valve)



The take-off blocks, when equipped with a no return valve, allow the use of non lubricated air and should be inserted between the regulator and the lubricator. If mounted as last element, they should be assembled with terminal flanges.

GENERAL DATA

Construction	modular, compact
Materials	zama, NBR, technopolymer
Ports	G1/4 G1/2
Weight	kg 0,232 kg 0,379
Take off ports	G1/4 G1/2
Mounting	in- line or wall mounting (in any position)
Operating temperature	-5°C ÷ 50°C (with the dew point of the fluid lower than 2°C at the min. working temperature)
Finishing	enamelled
Operating pressure	0 ÷ 16 bar
Nominal flow (6 bar ΔP 1bar)	MC1-B = 4080 NI/min MC1-B-VNR = 2350 NI/min MC2-B = 8400 NI/min MC2-B-VNR = 5600 NI/min
Fluid	Compressed air

CODING EXAMPLE

MC	2	-	B	-	VNR
MC	SERIES				
2	SIZE: 1 = G1/4 2 = G1/2				
B	B = TAKE OFF BLOCK				
VNR	VERSION: = standard VNR = with no return valve				

SERIES MC TAKE-OFF BLOCKS

Take off blocks Series MC



BL01 = take-off block
BL02 = take-off block with VNR

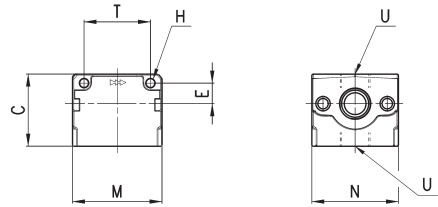
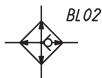

Mod.	C	H	E	M	N	T	U
MC1-B	43	4,5	11	45	45	35	G1/4
MC1-B-VNR	43	4,5	11	45	45	35	G1/4
MC2-B	50	5,5	14	62	60	46	G1/2
MC2-B-VNR	50	5,5	14	62	60	46	G1/2