

TECHNICAL TUBING AND ACCESSORIES

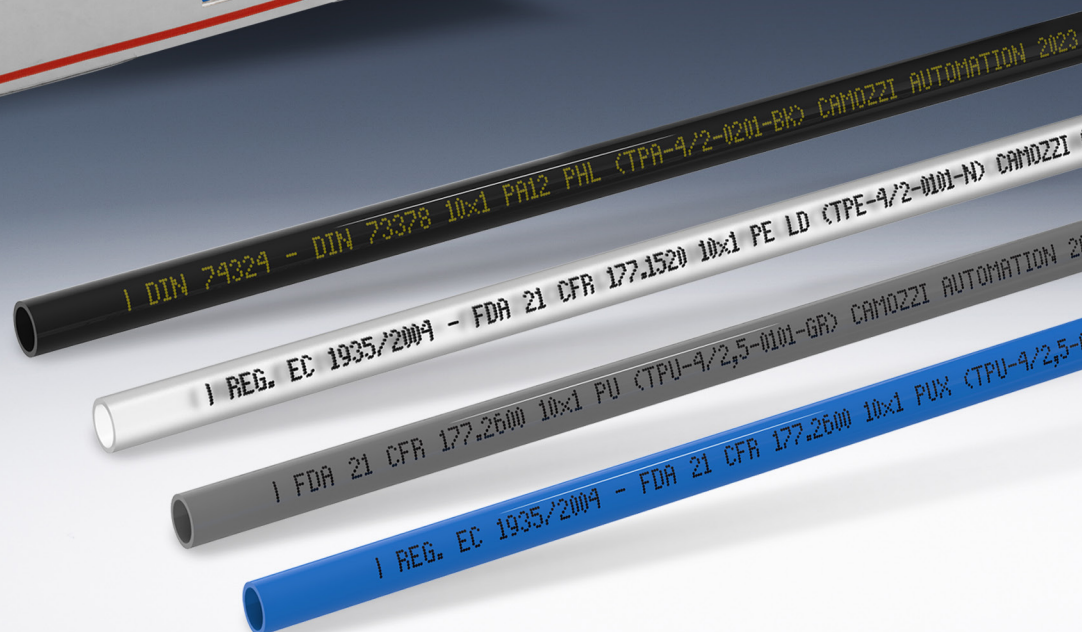



Camozzi Automation, the Italian multinational and leading producer of components and systems for the Industrial **Automation, Transportation and Life Science** sectors, has added a new range of flexible tubes to its portfolio.

These Camozzi branded flexible tubes are available in different materials and colours to perfectly meet any application need and are made using quality materials including **Polyamide (12 HL, PHL, HIPHL), Polyurethane (Ester 98 Shore, Ether 98 Shore, Anti-Spark 90 Shore) and Polyethylene LD**. In addition, it is possible to combine different colours, such as Black, Blue, Grey RAL 7012 and transparent, ensuring perfect integration with any work environment.

To simplify product handling and storage, protecting them from external contamination or dust, we also supply the tubes in practical **cardboard boxes** printed with the **Camozzi logo, in sizes of 25 and Box 100** metres. Each box comes with a **descriptive label and barcode**, making it easier to identify and manage the product.

These tubes **perfectly compliment** our well-established range of fittings, providing reliable connections for handling liquid and gaseous fluids in **industrial applications**.

TUBES INDEX

TECHNICAL TUBING AND ACCESSORIES

POLYAMIDE PA12 PHL (TRN)

- High resistance to aging
- Good heat resistance
- Excellent hydrolysis resistance
- Good CNG/LPG resistance



POLYAMIDE PA12 HIPHL

- Good flexibility even at low temperatures
- High resistance to high and low temperatures
- High chemical resistance
- High tensile strength



POLYAMIDE PA12 HL (TSR, TRSR)

- High resistance to aging
- Good heat resistance
- Good hydrocarbon and oil resistance
- Proper for higher pressures

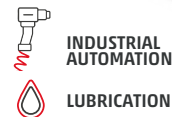

POLYURETHANE PU ESTER (TPC)

- Excellent flexibility and durability
- Small bend radius
- Shore Hardness A 98
- High abrasion resistance

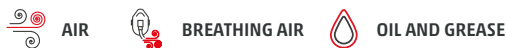

POLYURETHANE PU ETHER

- Transparent
- Excellent hydrolysis resistance
- Good kinking resistance
- Shore Hardness A 98



POLYURETHANE PU ANTI-SPARK

- Spark-proof and self-extinguishing
- Compliant to UL94 V0
- Halogen free
- Good abrasion resistance

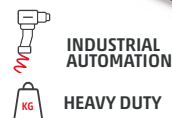

POLYETHYLENE PE LD (TPE)

- Wide chemical compatibility
- Food-safe compatibility
- High performance at low temperatures
- High resistance to aging

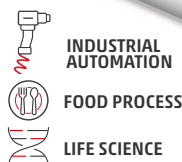

POLYAMIDE PA12 PHL (TRN)

TPA PHL



**INDUSTRIAL
AUTOMATION**



TRANSPORTATION



**WATER AND WATER-
BASED FLUIDS**



AIR



TECHNICAL TUBING AND ACCESSORIES

High-quality polyamide tubes offer reliable performance for multiple fluids at different temperatures.

- High resistance to aging
- Good heat resistance
- Excellent hydrolysis resistance
- Good CNG/LPG resistance

MAIN TECHNICAL FEATURES

Operating Temperature with air °C	-40 ÷ +80
Operating Temperature with water base °C	70
Max temperature °C	100
Operating pressure at 20°C (bar)	12 - 44
Min. bend radius mm	16 - 85
Specific weight g/m	9,7 - 35,6
Box m	25 and 100
Standard Size mm	4/2; 6/4; 8/6; 10/8; 12/10
Standards	REACH, RoHS DIN 73378 DIN 74324

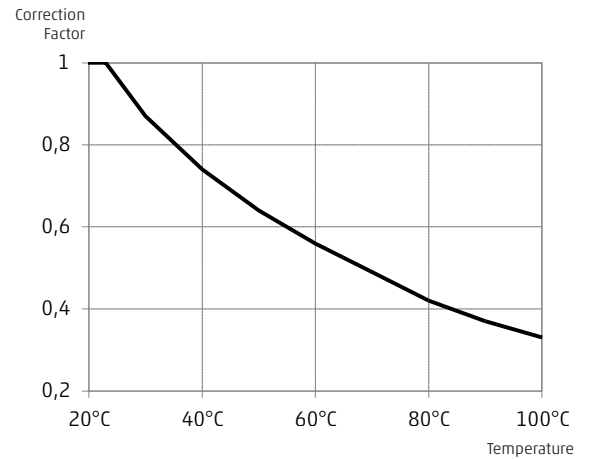

Box 25 m

Box 100 m

Box 25 m

TRANSPARENT	BLACK	BLUE	External Ø mm	Internal Ø mm	Thickness tube mm	Operating pressure bar	Bend radius mm	Specific weight g/m
TPA-4/2-0101-N-B25	TPA-4/2-0101-BK-B25	TPA-4/2-0101-B-B25	4	2	1	44	16	9,7
TPA-6/4-0101-N-B25	TPA-6/4-0101-BK-B25	TPA-6/4-0101-B-B25	6	4	1	28	30	16,2
TPA-8/6-0101-N-B25	TPA-8/6-0101-BK-B25	TPA-8/6-0101-B-B25	8	6	1	20	40	22,6
TPA-10/8-0101-N-B25	TPA-10/8-0101-BK-B25	TPA-10/8-0101-B-B25	10	8	1	16	60	29,1
TPA-12/10-0101-N-B25	TPA-12/10-0101-BK-B25	TPA-12/10-0101-B-B25	12	10	1	12	85	35,6

Black tubing is recommend for outdoor applications.

Box 100 m

TRANSPARENT	BLACK	BLUE	External Ø mm	Internal Ø mm	Thickness tube mm	Operating pressure bar	Bend radius mm	Specific weight g/m
TPA-4/2-0101-N-B100	TPA-4/2-0101-BK-B100	TPA-4/2-0101-B-B100	4	2	1	44	16	9,7
TPA-6/4-0101-N-B100	TPA-6/4-0101-BK-B100	TPA-6/4-0101-B-B100	6	4	1	28	30	16,2
TPA-8/6-0101-N-B100	TPA-8/6-0101-BK-B100	TPA-8/6-0101-B-B100	8	6	1	20	40	22,6
TPA-10/8-0101-N-B100	TPA-10/8-0101-BK-B100	TPA-10/8-0101-B-B100	10	8	1	16	60	29,1
TPA-12/10-0101-N-B100	TPA-12/10-0101-BK-B100	TPA-12/10-0101-B-B100	12	10	1	12	85	35,6

Black tubing is recommend for outdoor applications.

RECOMMENDED FITTINGS



SERIES 6000



SERIES 7000-AUTOMATION



SERIES 7000-COOLING



SERIES 8000, H8000



SERIES 9000



SERIES 1000



SERIES 1000 UNIVERSAL

POLYAMIDE PA12 HIPHL

TPA HIPHL



	INDUSTRIAL AUTOMATION		TRANSPORTATION
	AIR		COLD AND HOT WATER

High-quality polyamide tubes offer reliable performance for multiple fluids at both high and low temperatures.

- Good flexibility even at low temperatures
- High resistance to high and low temperatures
- High chemical resistance
- High tensile strength

MAIN TECHNICAL FEATURES

Operating Temperature with air °C	-55 ÷ +100
Operating Temperature with water base °C	70
Max temperature °C	100
Operating pressure at 20°C (bar)	21 - 49
Min. bend radius mm	16 - 60
Specific weight g/m	9,6 - 50,4
Box m	25 and 100
Standard Size mm	4/2,5; 6/4; 8/6; 10/8; 12/9
Standards	REACH, RoHS DIN 73378 DIN 74324

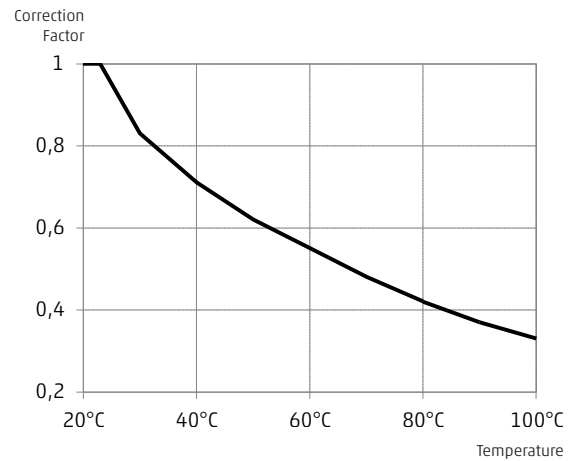

Box 25 m

Box 100 m

Box 25 m							
BLACK	External Ø mm	Internal Ø mm	Thickness tube mm	Operating pressure bar	Bend radius mm		Specific weight g/m
TPA-4/2-0501-BK-B25	4	2	1	49	16		9,6
TPA-6/4-0501-BK-B25	6	4	1	29	30		16
TPA-8/6-0501-BK-B25	8	6	1	21	40		22,4
TPA-10/8-0501-BK-B25	10	8	1	16	60		28,8
TPA-12/9-0501-BK-B25	12	9	1,50	21	60		50,4

Box 100 m							
BLACK	External Ø mm	Internal Ø mm	Thickness tube mm	Operating pressure bar	Bend radius mm		Specific weight g/m
TPA-4/2-0501-BK-B100	4	2	1	49	16		9,6
TPA-6/4-0501-BK-B100	6	4	1	29	30		16
TPA-8/6-0501-BK-B100	8	6	1	21	40		22,4
TPA-10/8-0501-BK-B100	10	8	1	16	60		28,8
TPA-12/9-0501-BK-B100	12	9	1,50	21	60		50,4

RECOMMENDED FITTINGS

SERIES 6000	SERIES 7000-AUTOMATION	SERIES 7000-COOLING	SERIES 8000, H8000	SERIES 9000	SERIES 1000	SERIES 1000 UNIVERSAL

POLYAMIDE PA12 HL (TSR, TRSR)

TPA HL



**INDUSTRIAL
AUTOMATION**



LUBRICATION



**WATER AND WATER-
BASED FLUIDS**



OIL AND GREASE



FUEL



High-quality rigid polyamide tubes are ideal for misting and lubricating applications.

- High resistance to aging
- Good heat resistance
- Good hydrocarbon and oil resistance
- Proper for higher pressure

MAIN TECHNICAL FEATURES

Operating Temperature with air °C	-40 ÷ +100
Operating Temperature with water base °C	70
Max temperature °C	125
Operating pressure at 20°C (bar)	87 - 91
Min. bend radius mm	25 - 120
Specific weight g/m	9,5 - 89
Box m	25 and 100
Standard Size mm	4/2,5; 6/3; 6,35/3; 9,53/5; 12,7/7
Standards	REACH, RoHS DIN 73378 DIN 74324 not for (6,35/3; 9,53/5; 12,7/7)

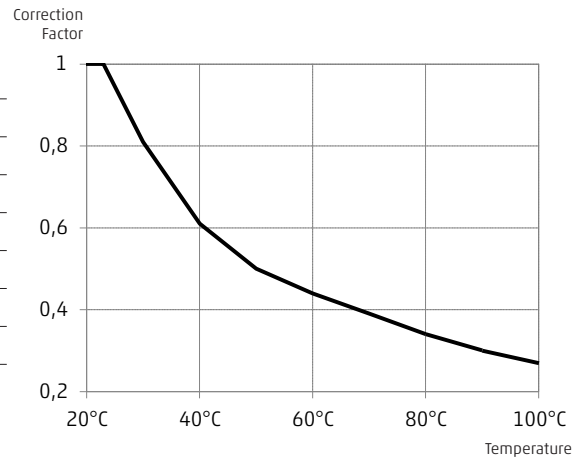

Box 25 m

Box 100 m

Box 25 m							
BLACK	External Ø mm	Internal Ø mm	Thickness tube mm	Operating pressure bar	Bend radius mm		Specific weight g/m
TPA-4/2-0201-BK-B25	4	2	1	91	25		9,5
TPA-6/3-0201-BK-B25	6	3	1,50	93	36		21,4
TPA-6,35/3-0201-BK-B25	6,35	3	1,675	95	40		24,8
TPA-9,53/5-0201-BK-B25	9,53	5	2,26	87	120		52
TPA-12,7/7-0201-BK-B25	12,70	7	2,85	87	120		89

Box 100 m							
BLACK	External Ø mm	Internal Ø mm	Thickness tube mm	Operating pressure bar	Bend radius mm		Specific weight g/m
TPA-4/2-0201-BK-B100	4	2	1	91	25		9,5
TPA-6/3-0201-BK-B100	6	3	1,50	93	36		21,4
TPA-6,35/3-0201-BK-B100	6,35	3	1,675	95	40		24,8
TPA-9,53/5-0201-BK-B100	9,53	5	2,26	87	120		52
TPA-12,7/7-0201-BK-B100	12,70	7	2,85	87	120		89

RECOMMENDED FITTINGS



SERIES 6000 MISTING



SERIES HP6000



SERIES 8000, H8000

POLYURETHANE PU ESTER (TPC)

TPU ESTER



INDUSTRIAL AUTOMATION



LIFE SCIENCE



AIR



BREATHING AIR



OIL AND GREASE



Ester-based polyurethane tubes offer excellent flexibility and a small bend radius. In addition to excellent durability, they offer good resistance against ruptures, abrasions, and kinking.

- Excellent flexibility and durability
- Small bend radius
- Shore Hardness A 98
- High abrasion resistance

MAIN TECHNICAL FEATURES

Operating Temperature with air °C	-20 ÷ +60
Operating pressure at 20°C (bar)	9 - 13
Min. bend radius mm	15 - 50
Specific weight g/m	9,3 - 76,6
Box m	25 and 100
Standard Size mm	4/2,5; 6/4; 8/6; 10/8; 12/8
Standards	REACH, RoHS EU 10/2011 (Raw material)* FDA 21 CFR 177.2600

* It is responsibility of the final user to ensure, through appropriate tests, the compliance of the finished products with the overall and specific migration limits required by the regulations.

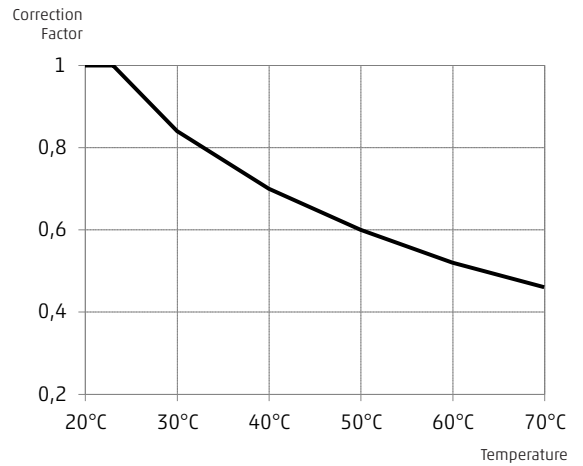

Box 25 m

Box 100 m

Box 25 m			External Ø mm	Internal Ø mm	Thickness tube mm	Operating pressure bar	Bend radius mm	Specific weight g/m
GREY (RAL 7012)	BLACK	BLUE						
TPU-4/2,5-0101-GR-B25	TPU-4/2,5-0101-BK-B25	TPU-4/2,5-0101-B-B25	4	2,5	0,75	13	15	9,3
TPU-6/4-0101-GR-B25	TPU-6/4-0101-BK-B25	TPU-6/4-0101-B-B25	6	4	1	13	18	19,2
TPU-8/6-0101-GR-B25	TPU-8/6-0101-BK-B25	TPU-8/6-0101-B-B25	8	6	1	9	35	26,8
TPU-10/8-0101-GR-B25	TPU-10/8-0101-BK-B25	TPU-10/8-0101-B-B25	10	8	1	7	45	34,5
TPU-12/8-0101-GR-B25	TPU-12/8-0101-BK-B25	TPU-12/8-0101-B-B25	12	8	2	9	50	76,6

Black tubing is recommend for outdoor applications.

Box 100 m			External Ø mm	Internal Ø mm	Thickness tube mm	Operating pressure bar	Bend radius mm	Specific weight g/m
GREY (RAL 7012)	BLACK	BLUE						
TPU-4/2,5-0101-GR-B100	TPU-4/2,5-0101-BK-B100	TPU-4/2,5-0101-B-B100	4	2,5	0,75	13	15	9,3
TPU-6/4-0101-GR-B100	TPU-6/4-0101-BK-B100	TPU-6/4-0101-B-B100	6	4	1	13	18	19,2
TPU-8/6-0101-GR-B100	TPU-8/6-0101-BK-B100	TPU-8/6-0101-B-B100	8	6	1	9	35	26,8
TPU-10/8-0101-GR-B100	TPU-10/8-0101-BK-B100	TPU-10/8-0101-B-B100	10	8	1	7	45	34,5
TPU-12/8-0101-GR-B100	TPU-12/8-0101-BK-B100	TPU-12/8-0101-B-B100	12	8	2	9	50	76,6

Black tubing is recommend for outdoor applications.

RECOMMENDED FITTINGS



SERIES 6000



SERIES 7000-AUTOMATION



SERIES 7000-COOLING



SERIES 8000, H8000



SERIES 1000



SERIES 1000 UNIVERSAL

POLYURETHANE PU ETHER

TPU ETHER



**INDUSTRIAL
AUTOMATION**



FOOD PROCESS



AIR



WATER AND WATER-BASED FLUIDS



FOOD PRODUCTS



TECHNICAL TUBING AND ACCESSORIES

Ether-based polyurethane tubes are transparent and offer excellent resistance to hydrolysis and microorganisms attack, flexibility and a small bend radius. In addition to excellent durability, they offer good resistance against ruptures, abrasions, and kinking.

- Transparent
- Excellent hydrolysis resistance
- Good kinking resistance
- Shore Hardness A 98

MAIN TECHNICAL FEATURES

Operating Temperature with air °C	-20 ÷ +60
Operating pressure at 20°C (bar)	8 -13
Min. bend radius mm	15 - 50
Specific weight g/m	9,3 - 60,3
Box m	25 and 100
Standard Size mm	4/2,5; 6/4; 8/6; 10/7; 12/9
Standards	REACH, RoHS EU 10/2011 (Raw material) EU 1935/2004 (MOCA) FDA 21 CFR 177.2600

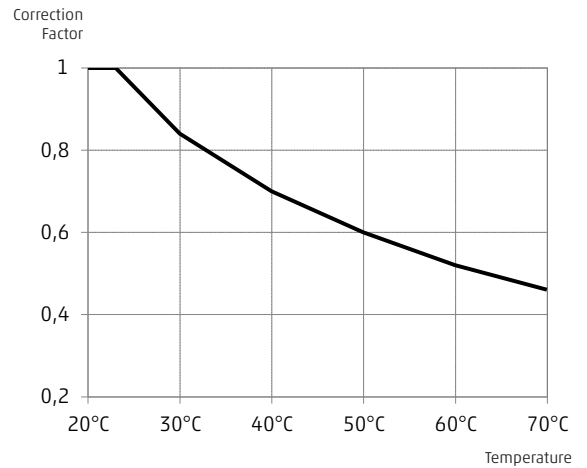

Box 25 m

Box 100 m

Box 25 m		External Ø mm	Internal Ø mm	Thickness tube mm	Operating pressure bar	Bend radius mm	Specific weight g/m
TRANSPARENT	BLUE						
TPU-4/2,5-0201-N-B25	TPU-4/2,5-0201-B-B25	4	2,5	0,75	13	15	9,3
TPU-6/4-0201-N-B25	TPU-6/4-0201-B-B25	6	4	1	13	18	19,2
TPU-8/6-0201-N-B25	TPU-8/6-0201-B-B25	8	6	1	9	35	26,8
TPU-10/7-0201-N-B25	TPU-10/7-0201-B-B25	10	7	1,5	11	30	48,8
TPU-12/9-0201-N-B25	TPU-12/9-0201-B-B25	12	9	1,5	8	50	60,3

Box 100 m		External Ø mm	Internal Ø mm	Thickness tube mm	Operating pressure bar	Bend radius mm	Specific weight g/m
TRANSPARENT	BLUE						
TPU-4/2,5-0201-N-B100	TPU-4/2,5-0201-B-B100	4	2,5	0,75	13	15	9,3
TPU-6/4-0201-N-B100	TPU-6/4-0201-B-B100	6	4	1	13	18	19,2
TPU-8/6-0201-N-B100	TPU-8/6-0201-B-B100	8	6	1	9	35	26,8
TPU-10/7-0201-N-B100	TPU-10/7-0201-B-B100	10	7	1,5	11	30	48,8
TPU-12/9-0201-N-B100	TPU-12/9-0201-B-B100	12	9	1,5	8	50	60,3

RECOMMENDED FITTINGS



SERIES 6000



SERIES 7000-AUTOMATION



SERIES 7000-COOLING



SERIES 7000-BEVERAGE



SERIES 8000, H8000



SERIES 1000



SERIES 1000 UNIVERSAL

POLYURETHANE PU ANTI-SPARK

TPU ANTI-SPARK



INDUSTRIAL AUTOMATION



HEAVY DUTY



AIR



WATER AND WATER-BASED FLUIDS



Single-layer, anti-spark and self-extinguishing, ether-based polyurethane tubes offer excellent resistance to abrasion, hydrolysis, weathering and ageing and are not vulnerable to 'click' and 'stress cracking' effects.

- Spark-proof and self-extinguishing
- Compliant to UL94 V0
- Halogen free
- Good abrasion resistance

MAIN TECHNICAL FEATURES

Operating Temperature with air °C	-20 ÷ +60
Operating pressure at 20°C (bar)	7 - 12
Min. bend radius mm	8 - 35
Specific weight g/m	11,6 - 77,2
Box m	25 and 100
Standard Size mm	4/2; 6/3; 8/4; 10/6; 12/8
Standards	REACH, RoHS UL94 V0, halogen free

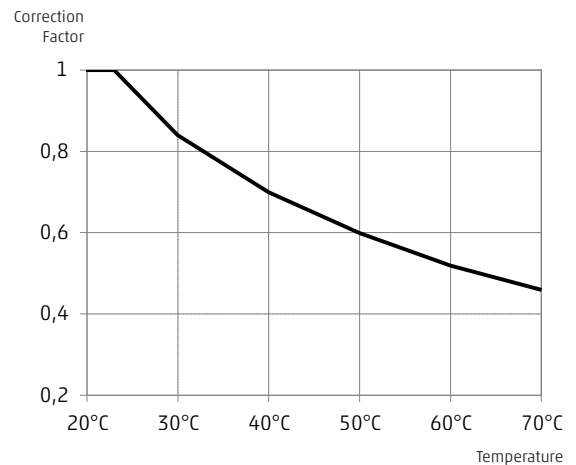

Box 25 m

Box 100 m

Box 25 m

BLACK	External Ø mm	Internal Ø mm	Thickness tube mm	Operating pressure bar	Bend radius mm	Specific weight g/m
TPU-4/2-0301-BK-B25	4	2	1	12	8	11,6
TPU-6/3-0301-BK-B25	6	3	1,5	11	10	26,1
TPU-8/4-0301-BK-B25	8	4	2	13	20	46,3
TPU-10/6-0301-BK-B25	10	6	2	9	25	61,8
TPU-12/8-0301-BK-B25	12	8	2	7	35	77,2

Box 100 m

BLACK	External Ø mm	Internal Ø mm	Thickness tube mm	Operating pressure bar	Bend radius mm	Specific weight g/m
TPU-4/2-0301-BK-B100	4	2	1	12	8	11,6
TPU-6/3-0301-BK-B100	6	3	1,5	11	10	26,1
TPU-8/4-0301-BK-B100	8	4	2	13	20	46,3
TPU-10/6-0301-BK-B100	10	6	2	9	25	61,8
TPU-12/8-0301-BK-B100	12	8	2	7	35	77,2

RECOMMENDED FITTINGS



SERIES 6000



SERIES 8000, H8000



SERIES 1000



SERIES 1000 UNIVERSAL

POLYETHYLENE PE LD (TPE)

PE LD



Low-density polyethylene tubes are ideal for food processing or fluid transmission applications. Utilising food-grade material allows continuous contact with food and beverages and provides a safe user environment.

- Wide chemical compatibility
- Food-safe compatibility
- High performance at low temperatures
- High resistance to aging

MAIN TECHNICAL FEATURES

Operating Temperature with air °C	-60 ÷ +40
Operating pressure at 20°C (bar)	7 - 21
Min. bend radius mm	19 - 76
Specific weight g/m	8,5 - 25,4
Box m	25 and 100
Standard Size mm	4/2; 6/4; 8/6; 10/8
Standards	REACH, RoHS REG UE 10/2011 (Raw material) FDA 21 CFR REG UE 1935/2004 (MOCA) D.M. 174 del 06/04/2004

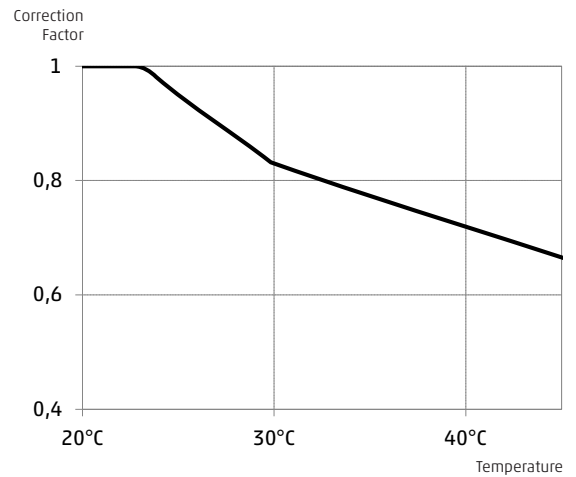

Box 25 m

Box 100 m

Box 25 m			External Ø mm	Internal Ø mm	Thickness tube mm	Operating pressure bar	Bend radius mm	Specific weight g/m
TRANSPARENT	BLACK	BLUE						
TPE-4/2-0101-N-B25			4	2	1	21	19	8,5
TPE-6/4-0101-N-B25	TPE-6/4-0101-BK-B25	TPE-6/4-0101-B-B25	6	4	1	13	32	14,1
TPE-8/6-0101-N-B25	TPE-8/6-0101-BK-B25	TPE-8/6-0101-B-B25	8	6	1	10	43	19,8
TPE-10/8-0101-N-B25	TPE-10/8-0101-BK-B25	TPE-10/8-0101-B-B25	10	8	1	7	76	25,4

Box 100 m			External Ø mm	Internal Ø mm	Thickness tube mm	Operating pressure bar	Bend radius mm	Specific weight g/m
TRANSPARENT	BLACK	BLUE						
TPE-4/2-0101-N-B100			4	2	1	21	19	8,5
TPE-6/4-0101-N-B100	TPE-6/4-0101-BK-B100	TPE-6/4-0101-B-B100	6	4	1	13	32	14,1
TPE-8/6-0101-N-B100	TPE-8/6-0101-BK-B100	TPE-8/6-0101-B-B100	8	6	1	10	43	19,8
TPE-10/8-0101-N-B100	TPE-10/8-0101-BK-B100	TPE-10/8-0101-B-B100	10	8	1	7	76	25,4

RECOMMENDED FITTINGS



ACCESSORIES

TECHNICAL TUBING AND ACCESSORIES

Plastic tubes clamps Mod. MPL

Colour: Blue

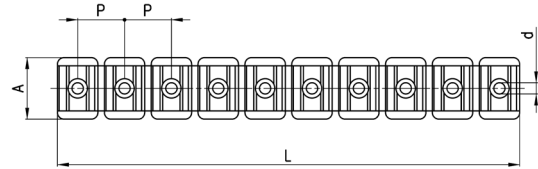

Mod.	Tube Ø	L	A	d	P	Number of positions
MPL-4	4	114	19	2.8	11.7	10
MPL-6	6	114	19	2.8	11.7	10
MPL-8	8	143	19	3.8	14.6	10
MPL-10	10	172	19	5.3	17.4	10
MPL-12	12	162	19	5.3	20.5	8
MPL-14	14	180	19	5.3	22.5	8

Tube cutter tool Mod. PNZ... and PNZP-12

Tube cutter Mod. PNZ...: replacement blades can be ordered separately.

Tube cutter Mod. PNZP-12: plastic.



PNZ-...



PNZP-12

Mod.	
PNZ-12	able to cut tubes with Ø up to 12 mm
PNZ-25	able to cut tubes with Ø up to Box 25 mm
PNZP-12	able to cut tubes with Ø up to 12 mm

Grooving tool for metallic tubes

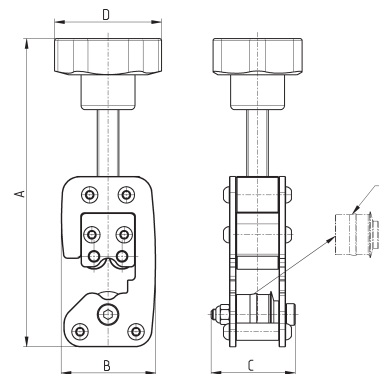

Mod.	Tube Ø	A (max)	B	C	D	Weight (g)	E (spare wheel)
8TRT 4	4	138	43.5	39	50	450	RTRT 4
8TRT 6	6	140	43.5	39	50	450	RTRT 6
8TRT 8	8	143	44	39	50	450	RTRT 8
8TRT 10	10	145	44	39	50	450	RTRT 10
8TRT 12	12	147	44.5	39	50	450	RTRT 12
8TRT 14	14	149	45	39	50	450	RTRT 14
8TRT 16	16	151	45	39	50	450	RTRT 16

Find out our new packaging Cardboard boxes that can be easily stacked in your shelf



Camozzi supplies the tubes in practical cardboard boxes branded with the Camozzi logo, in sizes of 25 and Box 100 metres. Each box comes with a descriptive label and barcode, making it easier to identify and manage, as well as protecting it from external contamination or dust.



Box 25 m



Box 100 m

CHEMICAL COMPATIBILITY

Find our table of compatibility on our website



Discover our complete range of fittings and related products designed to seamlessly connect with our new range of tubes.

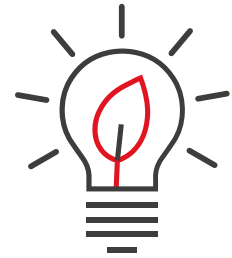

Series 6000, X6000, HP6000:
Super-rapid fittings



Series 6000M:
Misting



Series 7000 GRIPfit:
Push-in fittings



Series 8000, H8000:
Dual seal super-rapid fittings



Series 1000:
Rapid push-on fittings



Series 1000:
Universal nose fittings



Series 2000, S2000, X2000: pipe fittings (adapters)



Series 9000: Air brake fittings



Series 5000, 5000L LT: Quick-release couplings



Flow regulators: Flow control valves



Series VBU, VBO: Blocking valves



Series VNR: unidirectional valves



Series 29: Mini ball valves



Visit **Camozzi Automation's product catalogue and E-commerce site.**

Learn about our **full range of solutions** and keep up to date with our **latest news.**

Contacts

Camozzi Automation S.p.A.

REGISTERED OFFICE:

Via R. Rubattino, 81 - 20134 Milano (Italy)
P.IVA IT 03207930177

OPERATIONAL HEADQUARTERS:

Via Eritrea, 20/I - 25126 Brescia (Italy)
Tel. +39 03037921 | Info@camozzi.com
www.camozzi.com

Technical assistance

Tel. +39 030 3792790
service@camozzi.com

Product certification

Information concerning product certifications,
EC standards, conformity declarations and instructions
productcertification@camozzi.com



Automation

A Camozzi Group Company

www.camozzi.com