

Unidirectional valves

Series VNR

New models

Ports of Thread version: M5, G1/8, G1/4, G3/8, G1/2, G3/4, G1
 Dimensions of Tube/Tube version: Ø4; Ø6; Ø8; Ø10; Ø12



- » In-line mounting thanks to integrated fittings
- » Low operating pressures
- » Robust design, brass body
- » Version 6580 and 6510 in FKM with a wide range of chemical compatibility and operating temperatures extended.
- » Version for use with oxygen available

Series VNR unidirectional valves are available in the Thread or Integrated Fitting version. Thanks to their construction they operate at low pressures.

GENERAL DATA

| | |
|---------------------------|--|
| Valve group | automatic valves |
| Construction | poppet-type |
| Materials | brass body stainless steel spring NBR/FKM seals (for version 6580) |
| Mounting | in any position |
| Dimensions thread version | M5, G1/8, G1/4, G3/8, G1/2, G3/4, G1 |
| Dimensions tube version | Ø4; Ø6; Ø8 |
| Operating temperature | 0 °C ÷ 80 °C; NBR (with dry air -20 / +80 °C) FKM (with dry air -20 / +200 °C) |
| Medium | filtered air without lubrication. If lubricated air is used, it is recommended to use ISO VG32 oil. Once applied the lubrication should never be interrupted. |

Series VNR unidirectional valves

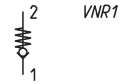
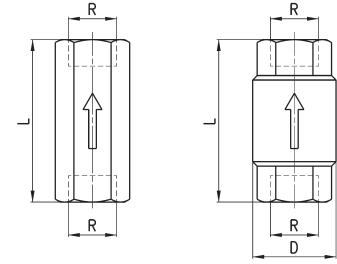
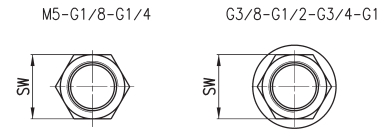

| DIMENSIONS | | | | | | | |
|-------------|------|------|----|------|---------------------------|----------------------------------|-------------------------------|
| Mod. | R | L | SW | D | Flow 6 bar ΔP1(Nl/min) | Min. operating pressure (bar) | Max working pressure (bar) |
| VNR-205-M5 | M5 | 25 | 8 | 9 | 50 | 1 | 10 |
| VNR-210-1/8 | G1/8 | 34 | 13 | 15 | 600 | 0.2 | 10 |
| VNR-843-07 | G1/4 | 43 | 17 | 20 | 1400 | 0.2 | 10 |
| VNR-238-3/8 | G3/8 | 55 | 23 | 34.5 | 3000 | 0.02 | 25 |
| VNR-212-1/2 | G1/2 | 58.5 | 27 | 34.5 | 5800 | 0.02 | 25 |
| VNR-234-3/4 | G3/4 | 65 | 33 | 41.5 | 8000 | 0.06 | 25 |
| VNR-201-01 | G1 | 74.5 | 40 | 48 | 13000 | 0.06 | 25 |

Series VNR unidirectional valves

New

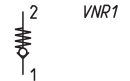
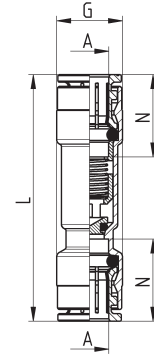

| Mod. | A | G | L | N | Flow 6 bar ΔP1(Nl/min) | Min. operating pressure (bar) | Max operating pressure (bar) | Weight (g) |
|------------------|----|------|------|------|---------------------------|----------------------------------|---------------------------------|---------------|
| 6580 4-VNR | 4 | 9 | 40 | 14 | 85 | 0,2 | 10 | 13 |
| 6580 6-VNR | 6 | 12 | 48 | 16 | 400 | 0,2 | 10 | 20 |
| 6580 8-VNR | 8 | 14 | 52,5 | 17,5 | 850 | 0,2 | 10 | 30 |
| 6580 10-VNR | 10 | 16,5 | 60 | 20,2 | 1500 | 0,2 | 10 | 40 |
| 6580 12-VNR | 12 | 19 | 60 | 19 | 2000 | 0,2 | 10 | 50 |
| 6580 4-VNR-OX1* | 4 | 9 | 40 | 14 | 85 | 0,2 | 10 | 13 |
| 6580 6-VNR-OX1* | 6 | 12 | 48 | 16 | 400 | 0,2 | 10 | 20 |
| 6580 8-VNR-OX1* | 8 | 14 | 52,5 | 17,5 | 850 | 0,2 | 10 | 30 |
| 6580 10-VNR-OX1* | 10 | 16,5 | 60 | 20,2 | 1500 | 0,2 | 10 | 40 |
| 6580 12-VNR-OX1* | 12 | 19 | 60 | 19 | 2000 | 0,2 | 10 | 50 |

*OX1 = for oxygen (non-volatile residue less than 550 mg/m²)

Series VNR unidirectional valves

New

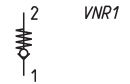
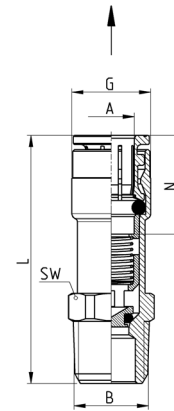

| Mod. | A | B | G | L | N | SW | Flow 6 bar ΔP1 (NL/min) | Min. operating pressure (bar) | Max operating pressure (bar) | Weight (g) |
|------------------|---|------|----|------|------|----|-------------------------|-------------------------------|------------------------------|------------|
| VNR60 4-M5 | 4 | M5 | 9 | 27.5 | 12 | 10 | 85 | 0.2 | 10 | 13 |
| VNR60 6-1/8 | 6 | R1/8 | 12 | 37.5 | 16 | 12 | 450 | 0.2 | 10 | 18 |
| VNR60 6-1/4 | 6 | R1/4 | 12 | 41 | 16 | 14 | 450 | 0.2 | 10 | 22 |
| VNR60 8-1/8 | 8 | R1/8 | 14 | 40.5 | 17.5 | 14 | 900 | 0.2 | 10 | 23 |
| VNR60 8-1/4 | 8 | R1/4 | 14 | 44 | 17.5 | 14 | 900 | 0.2 | 10 | 25 |
| VNR60 4-M5-OX1* | 4 | M5 | 9 | 27.5 | 12 | 10 | 85 | 0.2 | 10 | 13 |
| VNR60 6-1/8-OX1* | 6 | R1/8 | 12 | 37.5 | 16 | 12 | 450 | 0.2 | 10 | 18 |
| VNR60 6-1/4-OX1* | 6 | R1/4 | 12 | 41 | 16 | 14 | 450 | 0.2 | 10 | 22 |
| VNR60 8-1/8-OX1* | 8 | R1/8 | 14 | 40.5 | 17.5 | 14 | 900 | 0.2 | 10 | 23 |
| VNR60 8-1/4-OX1* | 8 | R1/4 | 14 | 44 | 17.5 | 14 | 900 | 0.2 | 10 | 25 |

*OX1 = for oxygen (non-volatile residue less than 550 mg/m²)

Series VNR unidirectional valves

New

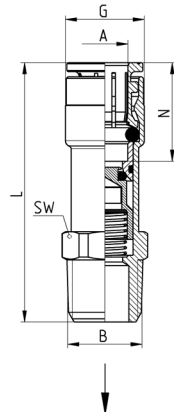

| Mod. | A | B | G | L | N | SW | Flow 6 bar ΔP1 (NL/min) | Min. operating pressure (bar) | Max operating pressure (bar) | Weight (g) |
|------------------|---|------|----|------|------|----|-------------------------|-------------------------------|------------------------------|------------|
| VNR60 M5-4 | 4 | M5 | 9 | 29.5 | 12 | 10 | 85 | 0.2 | 10 | 14 |
| VNR60 1/8-6 | 6 | R1/8 | 12 | 39.5 | 16 | 12 | 450 | 0.2 | 10 | 19 |
| VNR60 1/4-6 | 6 | R1/4 | 12 | 43 | 16 | 14 | 450 | 0.2 | 10 | 23 |
| VNR60 1/8-8 | 8 | R1/8 | 14 | 42.5 | 17.5 | 14 | 900 | 0.2 | 10 | 24 |
| VNR60 1/4-8 | 8 | R1/4 | 14 | 46 | 17.5 | 14 | 900 | 0.2 | 10 | 26 |
| VNR60 M5-4-OX1* | 4 | M5 | 9 | 29.5 | 12 | 10 | 85 | 0.2 | 10 | 14 |
| VNR60 1/8-6-OX1* | 6 | R1/8 | 12 | 39.5 | 16 | 12 | 450 | 0.2 | 10 | 19 |
| VNR60 1/4-6-OX1* | 6 | R1/4 | 12 | 43 | 16 | 14 | 450 | 0.2 | 10 | 23 |
| VNR60 8-1/8-OX1* | 8 | R1/8 | 14 | 42.5 | 17.5 | 14 | 900 | 0.2 | 10 | 24 |
| VNR60 1/4-8-OX1* | 8 | R1/4 | 14 | 46 | 17.5 | 14 | 900 | 0.2 | 10 | 26 |

*OX1 = for oxygen (non-volatile residue less than 550 mg/m²)