

New

Bellows suction pads (round) for Packaging

Series VPCQ - 4,5 folds

Suction pads in Silicone.
Diameters from 20 to 50 mm with thread size G1/8, G1/4, G3/8 and G1/2 both male and female.

SERIES VPCQ BELLOWS SUCTION PADS



- » The material, in compliance with the FDA Standard, allows direct contact with food.
- » Secure and reliable hold of flexible materials.
- » Optimum anti-collapse resistance due to the effect of vacuum

Series VPCQ suction pads consist of a nipple and rubber part which are delivered assembled. Both components can be ordered separately as spare parts.

These suction pads are very suitable for the handling of flexible products such as pouches and other rigid, plastic film packaging (like frozen food bags).

Common applications are:
 - Handling of pouches filled with solid, powder-form or liquid substances with a good level of filling
 - Quick packaging processes, mainly with a Delta Robot.

GENERAL DATA

Description	robust hard-wearing suction pads consisting of suction pad VPCQ and connection nipple
Construction	- nipples and suction pads are supplied already assembled - diameters of 60 mm and more: nipple screwed into supporting plate vulcanised to the pad
Maintenance	it is possible to replace the soft element
Working temperature	SILICONE version: -50°C ÷ +220°C (for short time <30 sec.); -30°C ÷ +180°C (long-term)

TECHNICAL DATA

Mod./Diameter	Suction force (N)*	Int. volume (cm ³)
VPCQ-0200	8	7,9
VPCQ-0300	16	15,7
VPCQ-0400	25	35,8
VPCQ-0500	50	64,6

CODING EXAMPLE

VP	C	Q	-	0200	S	-	G1/8	M
-----------	----------	----------	----------	-------------	----------	----------	-------------	----------

VP	SERIES VP = suction pad
C	SHAPE C = round
Q	VERSION Q = 4,5 folds
0200	DIAMETERS 0200 = 20,0 mm 0300 = 30,0 mm 0400 = 40,0 mm 0500 = 50,0 mm
S	MATERIALS S = silicone
G1/8	THREAD SIZE 1/8 = G1/8 1/4 = G1/4 3/8 = G3/8 1/2 = G1/2
M	THREAD M = male F = female

Suction pad VPCQ-0200 - male thread

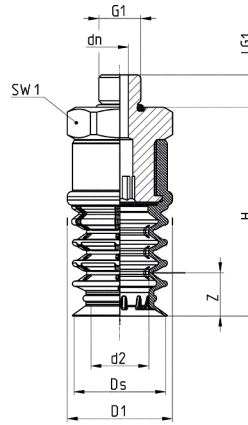

Tolerances for elastomer parts according to DIN ISO 3302-1 E3



Mod.	dn	d2	D1	Ds	G1	H	LG1	SW1	Z	Suction pad	Nipple
VPCQ-0200S-1/8M	4,0	13,5	24,4	21,4	G1/8 M	48,4	7,5	22	10	VPCQ-0200S	NPS-C-1/8-M
VPCQ-0200S-1/4M	8,0	13,5	24,4	21,4	G1/4 M	48,4	10,0	22	10	VPCQ-0200S	NPS-D-1/4-M
VPCQ-0200S-3/8M	10,3	13,5	24,4	21,4	G3/8 M	48,4	10,0	22	10	VPCQ-0200S	NPS-A-3/8-M

Suction pad VPCQ-0200 - female thread

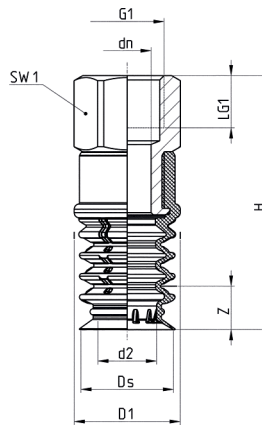

Tolerances for elastomer parts according to DIN ISO 3302-1 E3



Mod.	dn	d2	D1	Ds	G1	H	LG1	SW1	Z	Suction pad	Nipple
VPCQ-0200S-1/8F	8,6	13,5	24,4	21,4	G1/8 F	58,4	12,0	22	10	VPCQ-0200S	NPS-C-1/4-F
VPCQ-0200S-1/4F	11,0	13,5	24,4	21,4	G1/8 F	58,4	12,0	22	10	VPCQ-0200S	NPS-C-1/4-F
VPCQ-0200S-3/8F	11,0	13,5	24,4	21,4	G1/8 F	58,4	12,0	22	10	VPCQ-0200S	NPS-C-1/4-F

Suction pad VPCQ-0300 to 0500 - male thread



Tolerances for elastomer parts according to M3 - DIN 7715

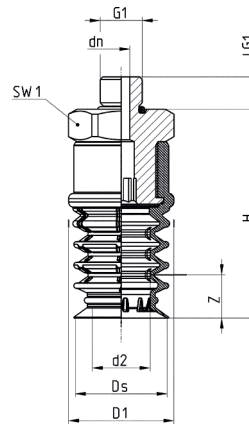

Mod.	dn	d2	D1	Ds	G1	H	LG1	SW1	Z	Suction pad	Nipple
VPCQ-0300S-1/8M	4,0	17,0	31,5	30,2	G1/8 M	59,5	7,5	22	20,0	VPCQ-0300S	NPS-C-1/8-M
VPCQ-0300S-1/4M	8,0	17,0	31,5	30,2	G1/4 M	59,5	10,0	22	20,0	VPCQ-0300S	NPS-D-1/4-M
VPCQ-0300S-3/8M	10,3	17,0	31,5	30,2	G3/8 M	59,5	10,0	22	20,0	VPCQ-0300S	NPS-A-3/8-M
VPCQ-0400S-1/4M	8,0	23,0	41,5	40,5	G1/4 M	73,1	10,0	27	27,0	VPCQ-0400S	NPS-B-3/8-M
VPCQ-0400S-1/2M	15,0	23,0	41,5	40,5	G1/2 M	73,1	14,0	27	27,0	VPCQ-0400S	NPS-A-1/2-M
VPCQ-0400S-3/8M	10,3	23,0	41,5	40,5	G3/8 M	73,1	10,0	27	27	VPCQ-0400S	NPS-A-1/2-M
VPCQ-0500S-1/4M	8,0	30,0	51,5	50,3	G1/4 M	83,5	10,0	27	37	VPCQ-0500S	NPS-B-1/4-M
VPCQ-0500S-1/2M	15,0	30,0	51,5	50,3	G1/2 M	83,5	14,0	27	37	VPCQ-0500S	NPS-A-1/2-M
VPCQ-0500S-3/8M	10,3	30,0	51,5	50,3	G3/8 M	83,5	10,0	27	37	VPCQ-0500S	NPS-B-3/8-M

Suction pad VPCQ-0300 to 0500 - female thread



Tolerances for elastomer parts according to DIN ISO 3302-1 E3

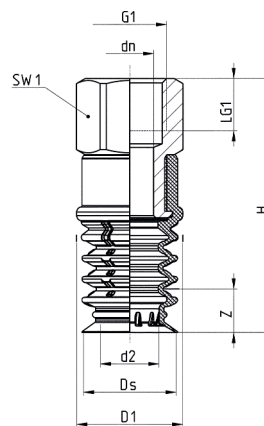

Mod.	dn	d2	D1	Ds	G1	H	LG1	SW1	Z	Suction pad	Nipple
VPCQ-0300S-1/8F	8,6	17,0	31,5	30,2	G1/8 F	69,5	12,0	22	20,0	VPCQ-0300S	NPS-C-1/8-F
VPCQ-0300S-1/4F	11,0	17,0	31,5	30,2	G1/4 F	69,5	12,0	22	20,0	VPCQ-0300S	NPS-C-1/4-F
VPCQ-0300S-3/8F	11,0	17,0	31,5	30,2	G3/8 F	69,5	12,0	22	20,0	VPCQ-0300S	NPS-A-3/8-F
VPCQ-0400S-1/4F	11,4	23,0	41,5	40,5	G1/4 F	87,1	12,0	27	27,0	VPCQ-0400S	NPS-B-3/8-F
VPCQ-0400S-1/2F	15,0	23,0	41,5	40,5	G1/2 F	87,1	16,0	27	27,0	VPCQ-0400S	NPS-A-1/2-F
VPCQ-0400S-3/8F	15,0	23,0	41,5	40,5	G3/8 F	87,1	12,0	27	27,0	VPCQ-0400S	NPS-A-1/2-F
VPCQ-0500S-1/4F	11,4	30,0	51,5	50,3	G1/4 F	97,5	12,0	27	37,0	VPCQ-0500S	NPS-D-1/4-F
VPCQ-0500S-1/2F	15,0	30,0	51,5	50,3	G1/2 F	97,5	16,0	27	37,0	VPCQ-0500S	NPS-A-1/2-F
VPCQ-0500S-3/8F	15,0	30,0	51,5	50,3	G3/8 F	97,5	12,0	27	37,0	VPCQ-0500S	NPS-B-3/8-F