

QUICK EXHAUST VALVES IN STAINLESS STEEL

SERIES XVSC



- Suitable to rapidly discharge air contained in tanks, systems or cylinder chamber
- Threaded version

Series XVSC quick exhaust valves are commonly used to increase the speed of cylinders or for rapid depressurisation of tanks containing compressed air.

GENERAL DATA

Valve group	automatic valves
Construction	poppet-type
Materials	316L stainless steel FKM seals 1/8 1/4 polyurethane seals 3/8 1/2
Mountings	in any position
Threads	G1/8, G1/4, G1/2, G3/8 1/8 NPT, 1/4 NPT, 3/8 NPT, 1/2 NPT
Operating temperature	1/8 1/4 GAS/NPT -10°C ÷ +120°C 3/8 1/2 GAS/NPT -20°C ÷ +80°C
Fluid	filtered air without lubrication

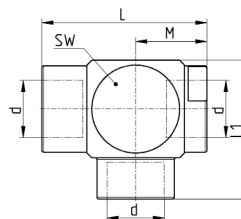
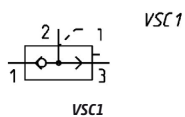
QUICK EXHAUST VALVES IN STAINLESS STEEL
SERIES XVSC - DIMENSIONAL CHARACTERISTICS
Series XVSC quick exhaust valves Mod. XSVC

Mod.	d	M	L	L1	SW
XVSC 1/8	G1/8	16	37	32	22
XVSC 1/4	G1/4	16,5	37,5	31,5	22
XVSC 3/8	G3/8	19	44	37	26
XVSC 1/2	G1/2	31	54	45	32
XVSC 1/8PT	1/8NPT	16	37	32	22
XVSC 1/4PT	1/4NPT	16	37	32	22
XVSC 3/8PT	3/8NPT	19	44	37	26
XVSC 1/2PT	1/2NPT	31	54	45	32