

- Fittings Mod. 1050

Product code: 1050 10-1/2

Datasheet creation date: 10/03/2025 10:32

Check the most updated document online [click here](#)



■ TECHNICAL DATA

| | |
|------|-------------|
| Mod. | 1050 10-1/2 |
|------|-------------|

- Fittings Mod. 1050

Product code: 1050 10-1/2

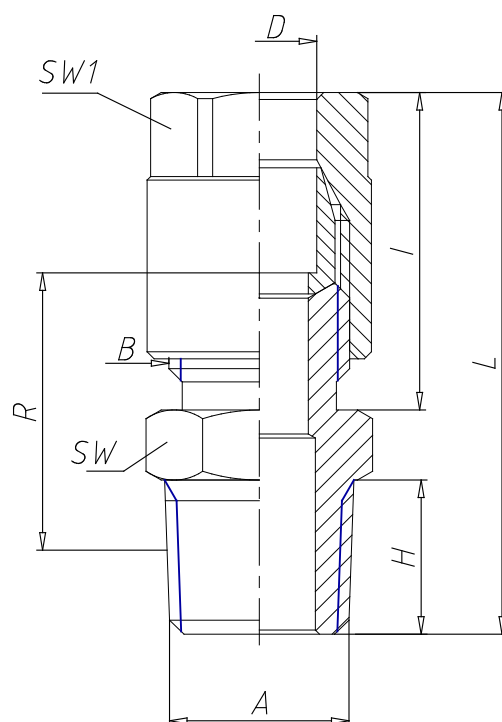

DIMENSIONS

| | |
|------------------------------|------|
| D (mm) | 10 |
| A | R1/2 |
| B | 3/8 |
| H (mm) | 14.0 |
| I (mm) | 25.5 |
| L (mm) | 45.0 |
| R (mm) | 18.0 |
| SW (mm) | 22 |
| SW1 (mm) | 17 |
| With bi-conical olive | - |