

## - Fittings Mod. 1050

Product code: 1050 10-3/8

Datasheet creation date: 10/03/2025 10:32

Check the most updated document online [click here](#)



### ■ TECHNICAL DATA

Mod.	1050 10-3/8
------	-------------

## - Fittings Mod. 1050

Product code: 1050 10-3/8

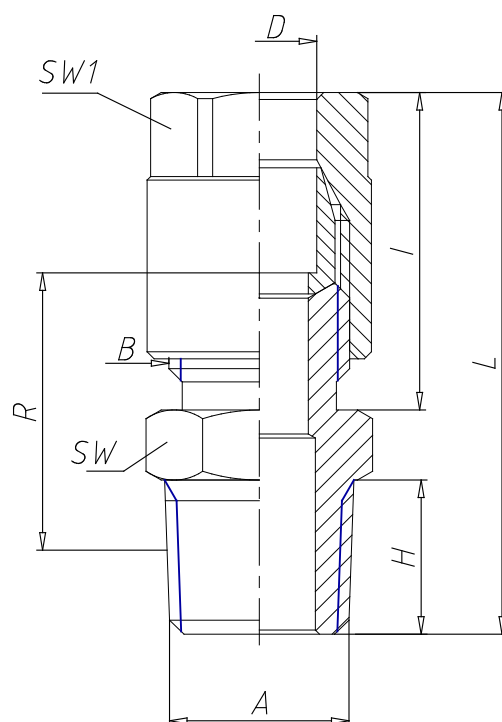

### ■ DIMENSIONS

<b>D (mm)</b>	10
<b>A</b>	R3/8
<b>B</b>	3/8
<b>H (mm)</b>	11.5
<b>I (mm)</b>	25.5
<b>L (mm)</b>	42.0
<b>R (mm)</b>	18.0
<b>SW (mm)</b>	17
<b>SW1 (mm)</b>	17
<b>With bi-conical olive</b>	-