

Mechanically operated valves - Series 1 and 3 / 138-945

Product code: 138-945

Datasheet creation date: 10/03/2025 12:05

Check the most updated document online [click here](#)



TECHNICAL DATA

Mod.	138-945
Operating pressure (bar)	0÷10 bar
Flow rate	500NL/min
Actuating force	70N
Activity	Actuating plunger

Mechanically operated valves - Series 1 and 3 / 138-945

Product code: 138-945

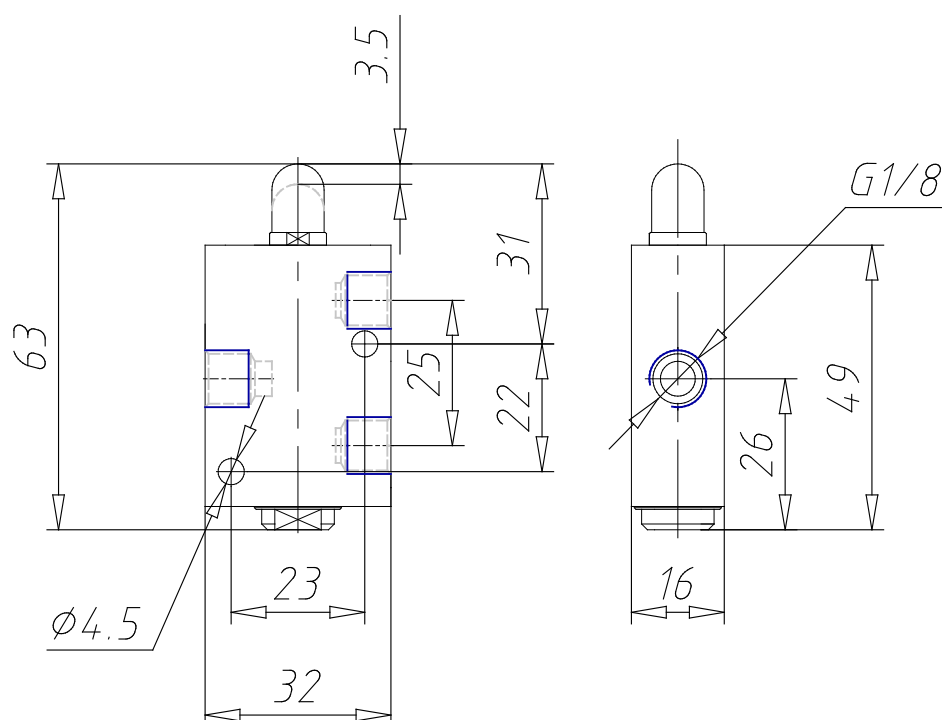

DIMENSIONS

Mod.	138-945
Operating pressure (bar)	0÷10 bar
Flow rate	500NL/min
Actuating force	70N
Activity	Actuating plunger