

## Mechanically operated valves - Series 1 and 3 / 148-945

Product code: 148-945

Datasheet creation date: 10/03/2025 12:05

Check the most updated document online [click here](#)



### TECHNICAL DATA

<b>Mod.</b>	148-945
<b>Operating pressure (bar)</b>	0÷10 bar
<b>Flow rate</b>	500NL/min
<b>Actuating force</b>	70N
<b>Activity</b>	Actuating plunger

## Mechanically operated valves - Series 1 and 3 / 148-945

Product code: 148-945

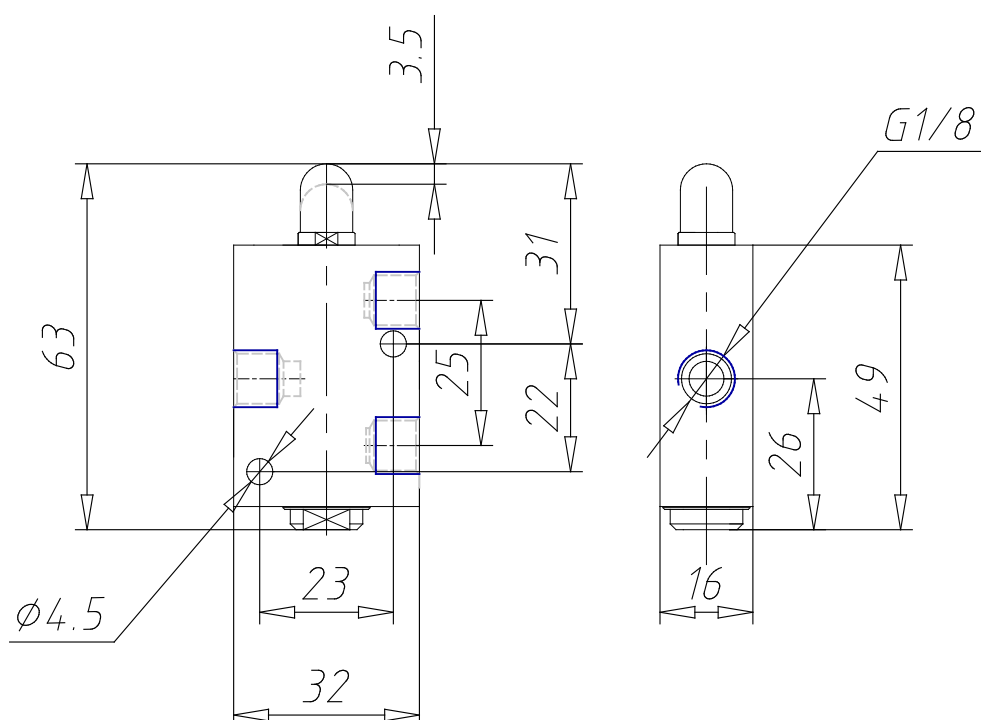

### DIMENSIONS

<b>Mod.</b>	148-945
<b>Operating pressure (bar)</b>	0÷10 bar
<b>Flow rate</b>	500NL/min
<b>Actuating force</b>	70N
<b>Activity</b>	Actuating plunger