

## Minicylinders - Series 16 - 23 - 24 - 25

Product code: 24N2A25A210

Datasheet creation date: 07/03/2025 18:24

Check the most updated document online [click here](#)



### TECHNICAL DATA

|                           |  |
|---------------------------|--|
| <b>Series (mm)</b>        | 24   |
| <b>Bore (mm)</b>          | 25   |
| <b>Version</b>            | N = standard   |
| <b>Operation</b>          | 2 = double acting  |
| <b>Materials</b>          | A = rolled stainless steel stem - stainless steel jacket |
| <b>Construction</b>       | A = ring nut V + stem nut U                              |
| <b>Stroke type</b>        | variable   |
| <b>Stroke (mm)</b>        | 210  |
| <b>Rod seals material</b> | = standard   |
| <b>Extended rod (mm)</b>  | 0  |

## Minicylinders - Series 16 - 23 - 24 - 25

Product code: 24N2A25A210

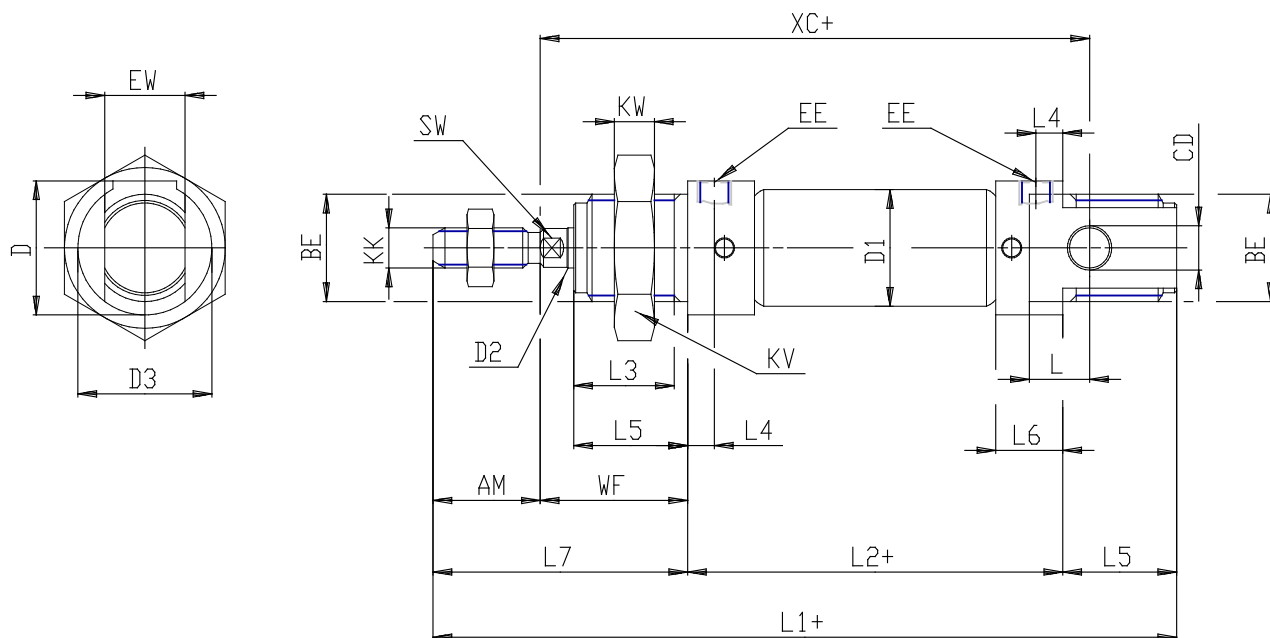

### DIMENSIONS

|          |          |
|----------|----------|
| EW (mm)  | 16       |
| KW (mm)  | 10       |
| BE       | M22x1,5  |
| KK       | M10x1,25 |
| ØCD (mm) | 8        |
| D1 (mm)  | 27.0     |
| EE       | G1/8     |
| ØD2 (mm) | 10       |
| L1 (mm)  | 351.5    |
| XC (mm)  | 314      |
| L2 (mm)  | 279.5    |
| AM (mm)  | 22       |
| L3 (mm)  | 20       |
| L4 (mm)  | 8.0      |
| L5 (mm)  | 22       |
| L (mm)   | 12       |
| WF (mm)  | 28       |
| L6 (mm)  | 16       |
| L7 (mm)  | 50       |
| KV (mm)  | 32       |
| SW (mm)  | 9        |
| D (mm)   | 27.0     |
| D3 (mm)  | 27       |