

## Minicylinders - Series 16 - 23 - 24 - 25

Product code: 24N3A20A250

Datasheet creation date: 07/03/2025 18:19

Check the most updated document online [click here](#)



### TECHNICAL DATA

<b>Series (mm)</b>	24
<b>Bore (mm)</b>	20
<b>Version</b>	N = standard
<b>Operation</b>	2 = double acting, through rod
<b>Materials</b>	A = rolled stainless steel stem - stainless steel jacket
<b>Construction</b>	A = ring nut V + stem nut U
<b>Stroke type</b>	standard
<b>Stroke (mm)</b>	250
<b>Rod seals material</b>	= standard
<b>Extended rod (mm)</b>	0

## Minicylinders - Series 16 - 23 - 24 - 25

Product code: 24N3A20A250

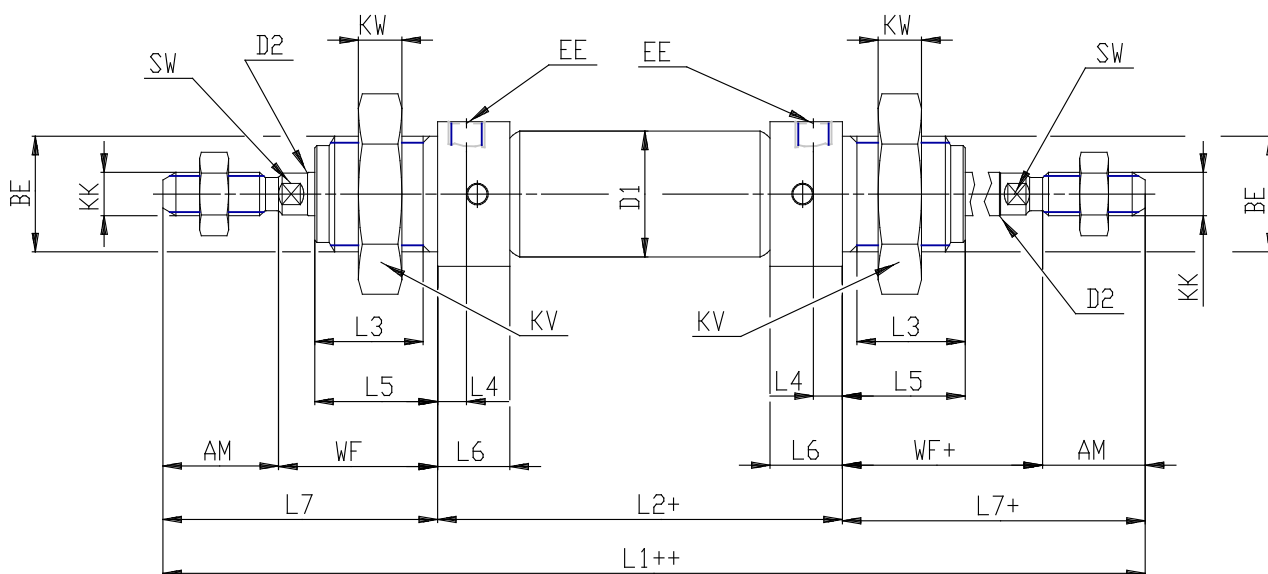

### DIMENSIONS

<b>EW (mm)</b>	16
<b>KW (mm)</b>	10
<b>BE</b>	M22x1,5
<b>KK</b>	M8x1,25
<b>ØCD (mm)</b>	8
<b>D1 (mm)</b>	22.0
<b>EE</b>	G1/8
<b>ØD2 (mm)</b>	8
<b>L1 (mm)</b>	656.0
<b>XC (mm)</b>	0
<b>L2 (mm)</b>	318.0
<b>AM (mm)</b>	20
<b>L3 (mm)</b>	18
<b>L4 (mm)</b>	8.0
<b>L5 (mm)</b>	20
<b>L (mm)</b>	12
<b>WF (mm)</b>	24
<b>L6 (mm)</b>	16
<b>L7 (mm)</b>	44
<b>KV (mm)</b>	32
<b>SW (mm)</b>	7
<b>D (mm)</b>	27.0
<b>D3 (mm)</b>	27