

3/2-way solenoid valve, G1/4, monostable - Series 4

Product code: 434-015-22

Datasheet creation date: 10/03/2025 11:58

Check the most updated document online [click here](#)



TECHNICAL DATA

| | |
|-----------------------------------|----------------------|
| Mod. | 434-015-22 |
| Function | 3/2 NC |
| Flow rate (NI/min) | 1250 |
| Operating pressure | 2.5 ÷ 10 |
| Type of manual override | = bistable, standard |
| Dimensions of the solenoid | No solenoid |
| Solenoid voltage | |

3/2-way solenoid valve, G1/4, monostable - Series 4

Product code: 434-015-22

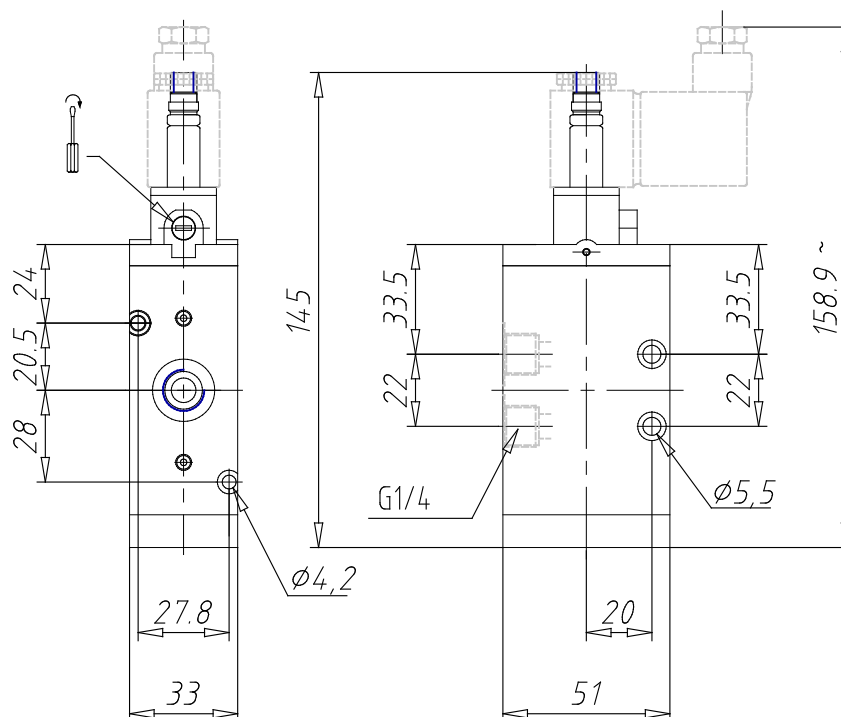

DIMENSIONS

| | |
|-----------------------------------|----------------------|
| Mod. | 434-015-22 |
| Function | 3/2 NC |
| Flow rate (NI/min) | 1250 |
| Operating pressure | 2.5 ÷ 10 |
| Type of manual override | = bistable, standard |
| Dimensions of the solenoid | No solenoid |
| Solenoid voltage | |