

3/2-way solenoid valve G1/8, monostable - Serie 4

Product code: 448-015-22-U7K

Datasheet creation date: 10/03/2025 12:00

Check the most updated document online [click here](#)



TECHNICAL DATA

Mod.	448-015-22
Function	3/2 NO
Flow rate (NI/min)	650
Operating pressure	2.5 ÷ 10
Type of manual override	= bistable, standard
Dimensions of the solenoid	U7 = PET / 22 x 22
Solenoid voltage	K=110V - 50/60Hz

3/2-way solenoid valve G1/8, monostable - Serie 4

Product code: 448-015-22-U7K

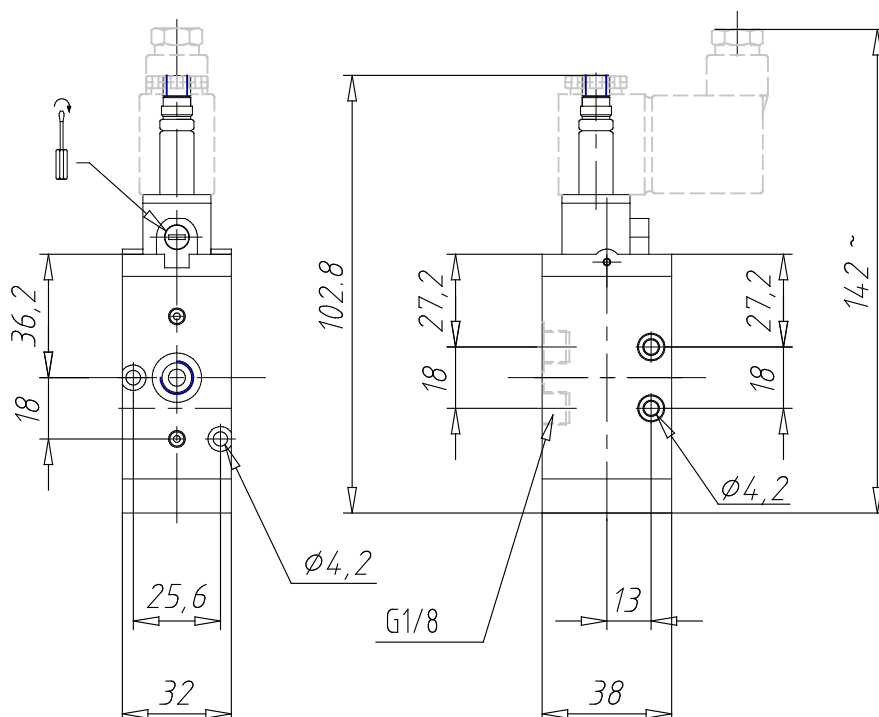

DIMENSIONS

Mod.	448-015-22
Function	3/2 NO
Flow rate (NI/min)	650
Operating pressure	2.5 ÷ 10
Type of manual override	= bistable, standard
Dimensions of the solenoid	U7 = PET / 22 x 22
Solenoid voltage	K=110V - 50/60Hz