

5/2-way solenoid valves, G1/8, monostable - Series 4

Product code: 458-015-22IM

Datasheet creation date: 10/03/2025 12:01

Check the most updated document online [click here](#)



TECHNICAL DATA

Mod.	458-015-22
Function	5/2
Flow rate (NI/min)	650
Operating pressure	2.5 ÷ 10
Type of manual override	IM = monostable (available on demand)
Dimensions of the solenoid	No solenoid
Solenoid voltage	

5/2-way solenoid valves, G1/8, monostable - Series 4

Product code: 458-015-22IM

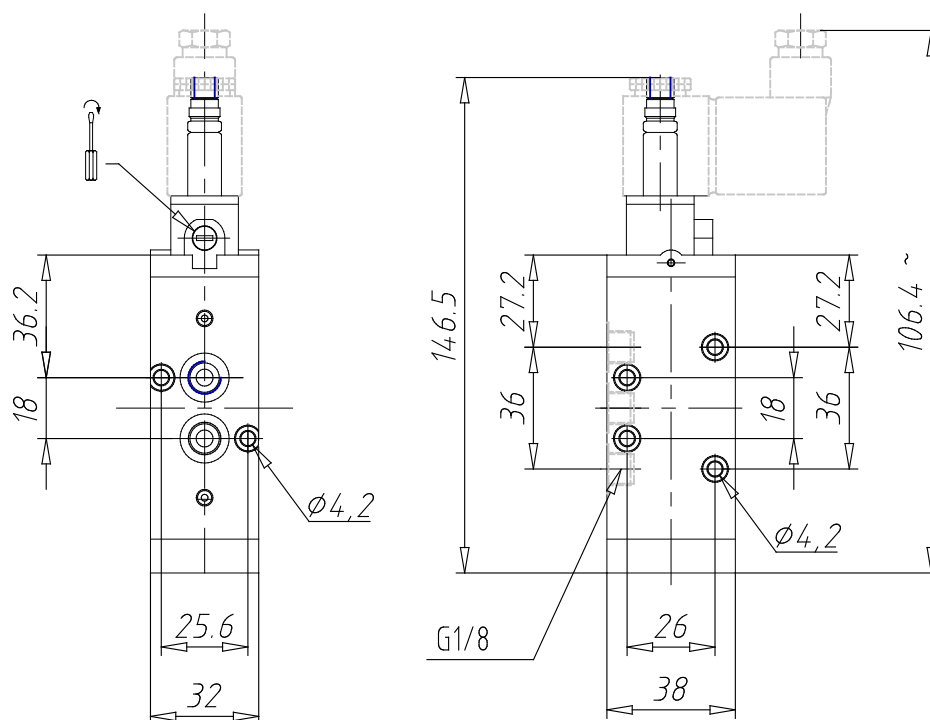

DIMENSIONS

Mod.	458-015-22
Function	5/2
Flow rate (NI/min)	650
Operating pressure	2.5 ÷ 10
Type of manual override	IM = monostable (available on demand)
Dimensions of the solenoid	No solenoid
Solenoid voltage	