

## Rotary cylinders - Series 69

Product code: 69-050/120-M

Datasheet creation date: 07/03/2025 17:48

Check the most updated document online [click here](#)



### TECHNICAL DATA

<b>Series</b>	69
<b>Diameter (mm)</b>	50
<b>Rotation (°)</b>	120
<b>Pinion</b>	M=male pinion
<b>Seals material</b>	= NBR

## Rotary cylinders - Series 69

Product code: 69-050/120-M

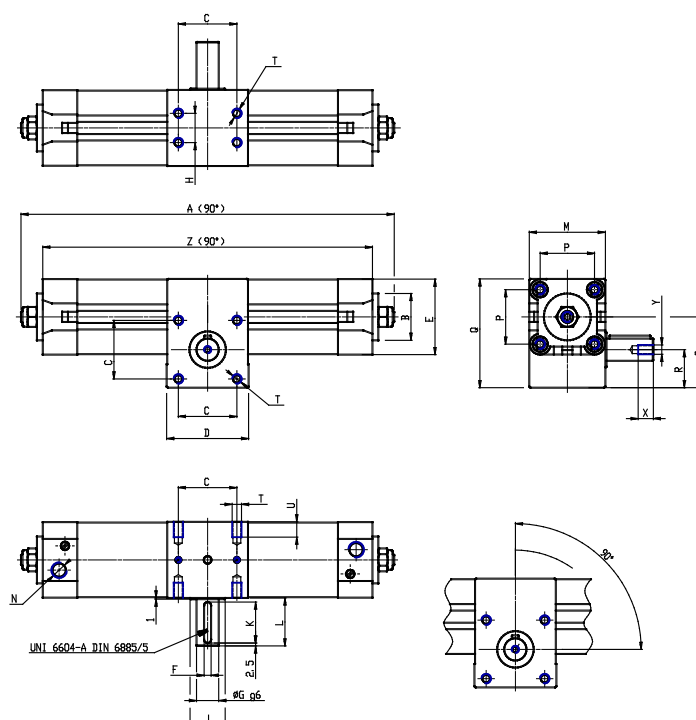

### DIMENSIONS

<b>A (mm)</b>	337.0
<b>B d11 (mm)</b>	40
<b>C (mm)</b>	50
<b>D (mm)</b>	70
<b>E (mm)</b>	64.5
<b>F (mm)</b>	6
<b>G (mm)</b>	19
<b>H (mm)</b>	25
<b>J (mm)</b>	30
<b>K (mm)</b>	35
<b>L (mm)</b>	41
<b>M (mm)</b>	65
<b>N</b>	G1/4
<b>P (mm)</b>	46.5
<b>Q (mm)</b>	94.0
<b>R (mm)</b>	32.5
<b>S (mm)</b>	60.5
<b>T</b>	M8
<b>U (mm)</b>	13
<b>V (mm)</b>	21.8
<b>W (mm)</b>	19
<b>Y</b>	M6
<b>X (mm)</b>	16.0
<b>Z (mm)</b>	303.0