

## Single sub-base with rear outlets (VDMA 24345) - Series 9

Product code: 902-G2A

Datasheet creation date: 07/03/2025 16:18

Check the most updated document online [click here](#)



### TECHNICAL DATA

|             |         |
|-------------|---------|
| <b>Mod.</b> | 902-G2A |
| <b>Size</b> | 2       |

## Single sub-base with rear outlets (VDMA 24345) - Series 9

Product code: 902-G2A

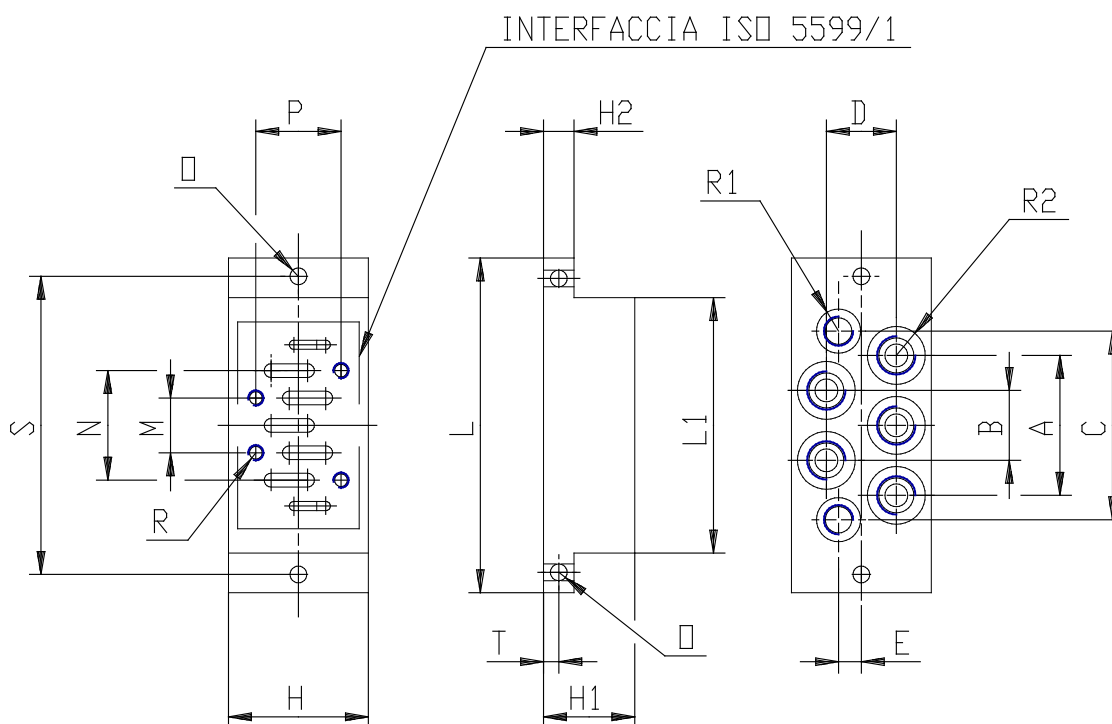

### DIMENSIONS

|      |      |
|------|------|
| (mm) | 56   |
| (mm) | 28   |
| (mm) | 72   |
| (mm) | 28   |
| (mm) | 8.0  |
| (mm) | 56   |
| (mm) | 35   |
| (mm) | 13   |
| (mm) | 124  |
| (mm) | 95   |
| (mm) | 6.5  |
|      | G1/8 |
|      | G3/8 |
| (mm) | 112  |