

• - **Series 97**

Product code: 97T2A063A0150

Datasheet creation date: 07/03/2025 17:44

Check the most updated document online [click here](#)



**TECHNICAL DATA**

|                             |  |
|-----------------------------|--|
| <b>Series (mm)</b>          | 97   |
| <b>Diameter (mm)</b>        | 63   |
| <b>Version (mm)</b>         | T = front and rear threaded end blocks                         |
| <b>Operation (mm)</b>       | 2 = double-acting (front and rear cushions)                    |
| <b>Materials (mm)</b>       | A = stainless steel AISI 304 - PU seals                        |
| <b>Construction (mm)</b>    | A = standard (locking ring for end cap V + lock nut for rod U) |
| <b>Stroke type</b>          | standard   |
| <b>Stroke (mm)</b>          | 150  |
| <b>rod seal in FKM (mm)</b> | -  |

• - Series 97

Product code: 97T2A063A0150

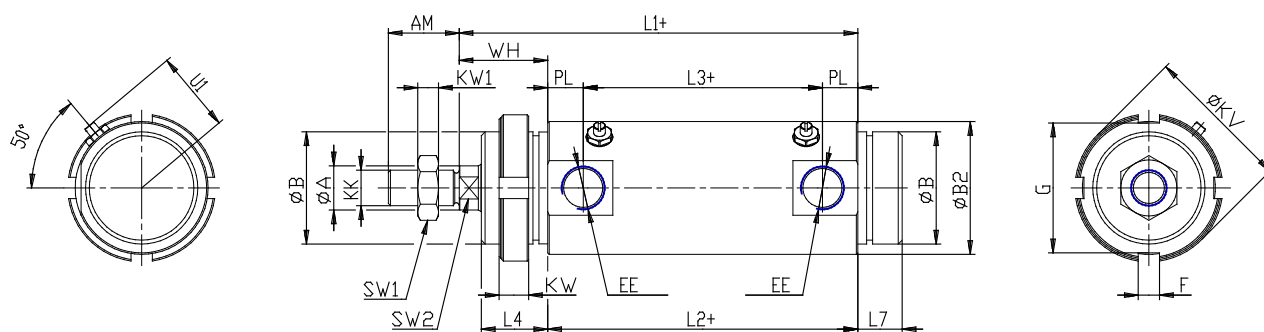

**DIMENSIONS**

|           |         |
|-----------|---------|
| Ø A (mm)  | 20      |
| AM (mm)   | 32      |
| Ø B (mm)  | M45X1.5 |
| Ø B2 (mm) | 68      |
| CB (mm)   | -       |
| CX (mm)   | -       |
| EE (mm)   | G 3/8   |
| EP (mm)   | -       |
| EX (mm)   | -       |
| EW (mm)   | -       |
| F (mm)    | 6       |
| G (mm)    | 53      |
| KK (mm)   | M16X1,5 |
| PL (mm)   | 13.0    |
| SW (mm)   | -       |
| SW1 (mm)  | 24      |
| KW1 (mm)  | 8       |
| SW2 (mm)  | 17      |
| U1 (mm)   | 40      |
| WH        | 37.0    |
| L1        | 158.0   |
| L2 (mm)   | 121.0   |
| L3 (mm)   | 95      |

|           |    |
|-----------|----|
| L4        | 28 |
| L7 (mm)   | 18 |
| L (mm)    | -  |
| LT (mm)   | -  |
| LU (mm)   | -  |
| KW (mm)   | 10 |
| Ø KV (mm) | 60 |
| XD (mm)   | -  |
| XG (mm)   | -  |
| TD (mm)   | -  |
| TL (mm)   | -  |
| UB (mm)   | -  |
| UT (mm)   | -  |
| ZC (mm)   | -  |
| Z (mm)    | -  |