

kit for axial connection - Mod. AR

Product code: AR-6E-50-R060P

Datasheet creation date: 07/03/2025 15:44

Check the most updated document online [click here](#)



TECHNICAL DATA

Mod.	AR-6E-50-R060P
Gearbox	GB-060-...

kit for axial connection - Mod. AR

Product code: AR-6E-50-R060P

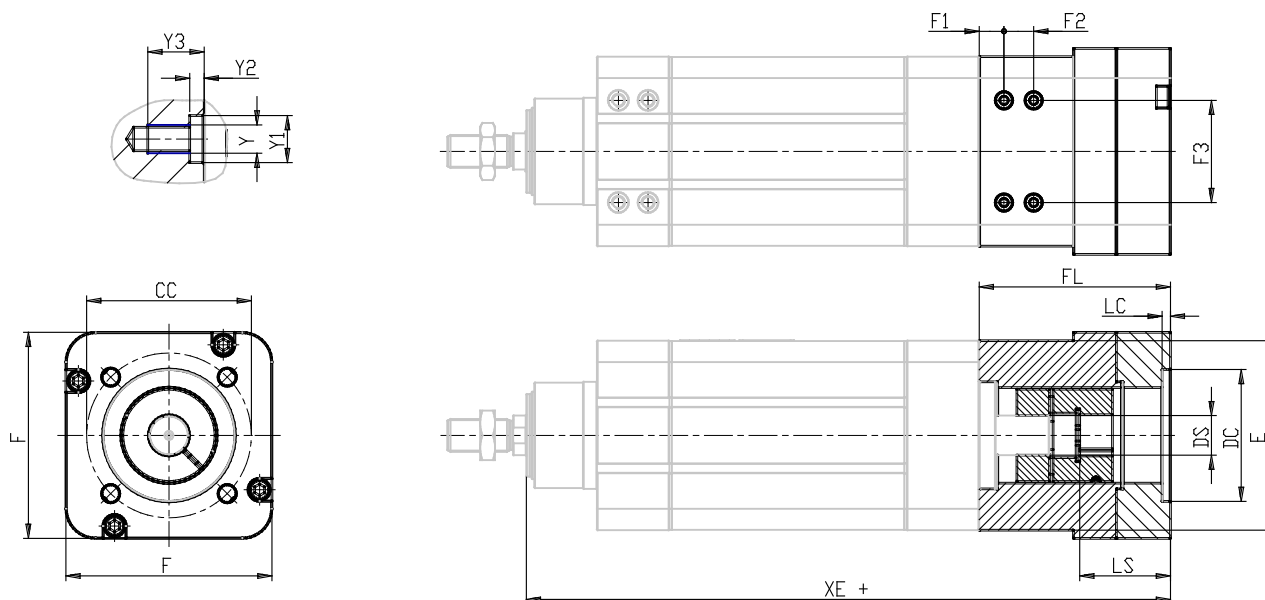

DIMENSIONS

XE (mm)	287.4
FL (mm)	76.4
F (mm)	0
E (mm)	64.9
DC (mm)	40
LC (mm)	3
CC (mm)	52
F1 (mm)	0
F2 (mm)	0
F3 (mm)	0
Y (mm)	0
Y1 (mm)	0
Y2 (mm)	0.0
Y3 (mm)	0.0
DS (mm)	14
LS (mm)	35
Weight (g)	630