

Series ASX angle seat valve - tri-clamp - Series ASX

Product code: ASX21-Y050K7-06312

Datasheet creation date: 10/03/2025 11:06

Check the most updated document online [click here](#)



TECHNICAL DATA

Series	AS
Actuator	X = metal actuator
Body material	2 = 316 stainless steel
Function	1 = 2/2 NC
Flow direction	Y = above seat
Diameter	DN 50
Connection	K7 = tri-clamp ISO 2852
Actuator size (mm)	Ø63 mm
Actuator material	1 = 304 stainless steel
Gaskets	2 = for standard temperature -10 / 180°C
Options	= none

Series ASX angle seat valve - tri-clamp - Series ASX

Product code: ASX21-Y050K7-06312

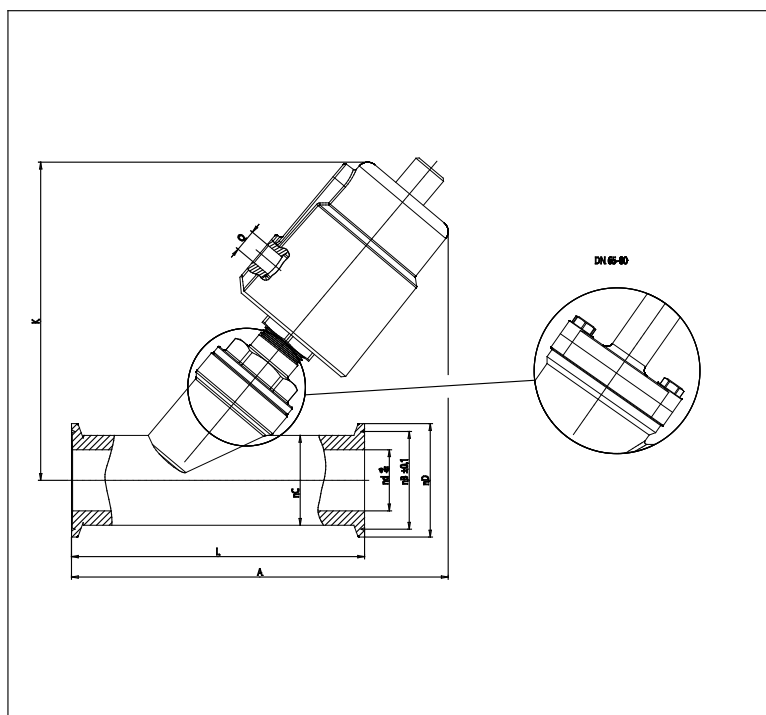

DIMENSIONS

DN	50
C	53
B	56.5
D	45
D2	64.0
A	221
K	185
L	175
Q	1/8"