

## Direct acting solenoid valves (with cables) - Series K

Product code: K000-303-KG2

Datasheet creation date: 10/03/2025 11:28

Check the most updated document online [click here](#)

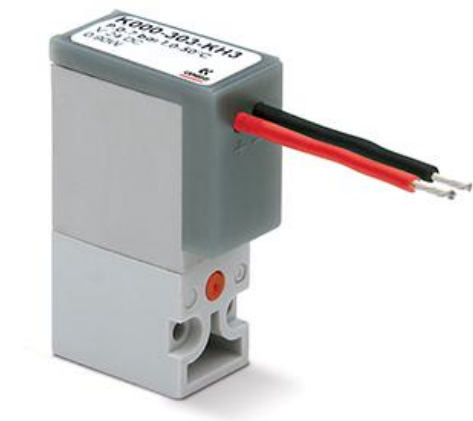

### TECHNICAL DATA

|                                    |   |
|------------------------------------|---|
| <b>Series</b>                      | K000  |
| <b>Number of ways - functions</b>  | 3 = 3/2 vie - NC  |
| <b>Thread port</b>                 | 0 = manifold or single base                                 |
| <b>Orifice diameter</b>            | 3 = Ø 0.6 mm - 3/2 version                                  |
| <b>Materials</b>                   | K = PBT body - HNBR poppet seal (only for 3/2-way versions) |
| <b>Electrical connection</b>       | B   |
| <b>Voltage - power consumption</b> | 2 = 12 V DC - 1 W   |
| <b>Fixing</b>                      | = fixing screws for plastic                                 |
| <b>Options</b>                     | = standard  |

## Direct acting solenoid valves (with cables) - Series K

Product code: K000-303-KG2

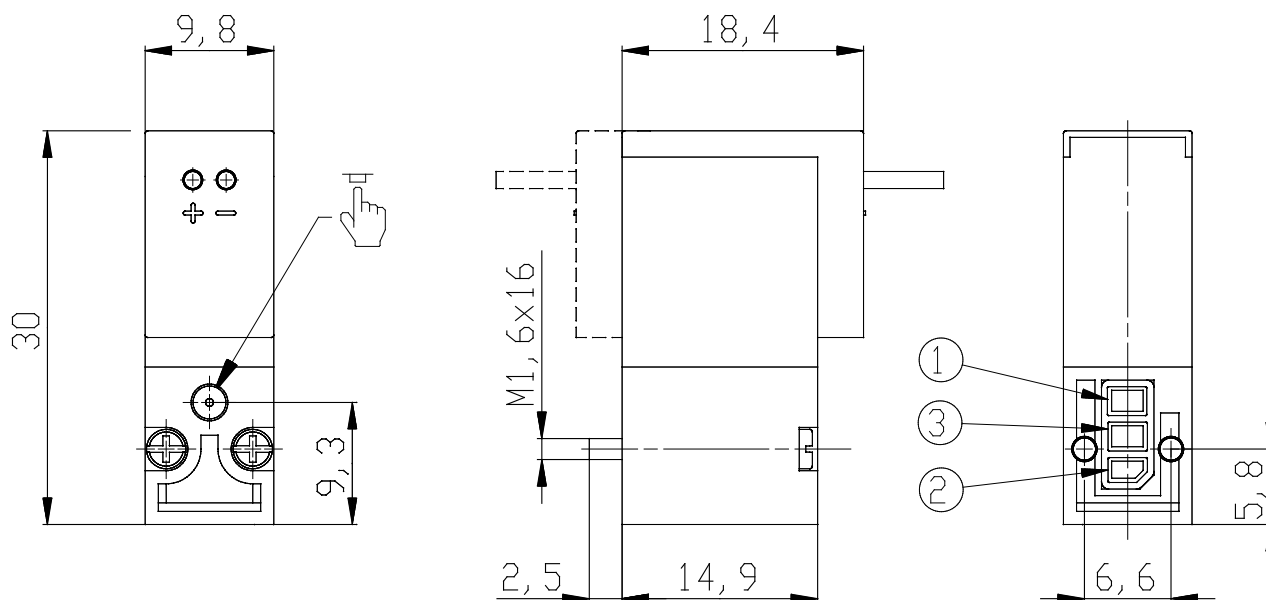

### DIMENSIONS

|                                    |   |
|------------------------------------|---|
| <b>Series</b>                      | K000  |
| <b>Number of ways - functions</b>  | 3 = 3/2 vie - NC  |
| <b>Thread port</b>                 | 0 = manifold or single base                                 |
| <b>Orifice diameter</b>            | 3 = Ø 0.6 mm - 3/2 version                                  |
| <b>Materials</b>                   | K = PBT body - HNBR poppet seal (only for 3/2-way versions) |
| <b>Electrical connection</b>       | B   |
| <b>Voltage - power consumption</b> | 2 = 12 V DC - 1 W   |
| <b>Fixing</b>                      | = fixing screws for plastic                                 |
| <b>Options</b>                     | = standard  |