

## Direct Operated Solenoid Valves with Separation Diaphragm - PDV Series

Product code: PDVC0122-A74GN-M003AC020

Datasheet creation date: 10/03/2025 11:40

Check the most updated document online [click here](#)



### TECHNICAL DATA

|                                   |                                      |
|-----------------------------------|--------------------------------------|
| <b>Series</b>                     | PDV                                  |
| <b>Body execution</b>             | C0 = body with interface for subbase |
| <b>Number of ways - functions</b> | 1 = 2/2 way - NC                     |
| <b>Pneumatic connections</b>      | 22 = PDV-type interface, 2-way       |
| <b>Orifice diameter</b>           | A7 = $\varnothing$ 0.8 mm            |
| <b>Materials held</b>             | 4 = EPDM                             |
| <b>Body materials</b>             | G = PEEK                             |
| <b>Manual intervention</b>        | N = not foreseen                     |
| <b>Fixing</b>                     | M = fixing screws for metal          |
| <b>Options</b>                    | 00 = none                            |
| <b>Electrical connection</b>      | 3A = DIN EN 175 301-803-C (8 mm)     |
| <b>Voltage - absorbed power</b>   | C020 = 12 V DC - 2 W                 |

## Direct Operated Solenoid Valves with Separation Diaphragm - PDV Series

Product code: PDVC0122-A74GN-M003AC020

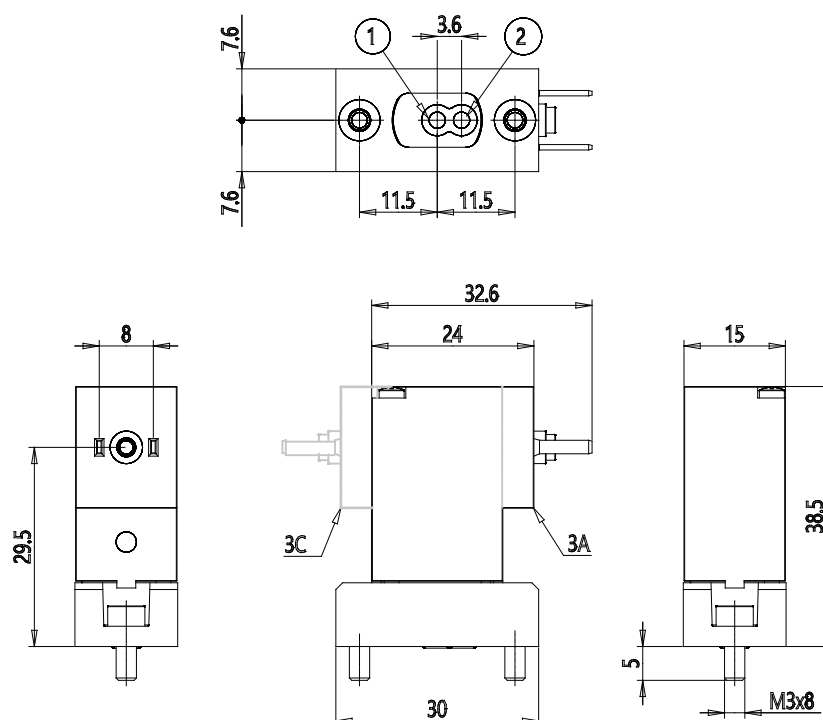

### DIMENSIONS

|                                   |                                      |
|-----------------------------------|--------------------------------------|
| <b>Series</b>                     | PDV                                  |
| <b>Body execution</b>             | C0 = body with interface for subbase |
| <b>Number of ways - functions</b> | 1 = 2/2 way - NC                     |
| <b>Pneumatic connections</b>      | 22 = PDV-type interface, 2-way       |
| <b>Orifice diameter</b>           | A7 = $\varnothing$ 0.8 mm            |
| <b>Materials held</b>             | 4 = EPDM                             |
| <b>Body materials</b>             | G = PEEK                             |
| <b>Manual intervention</b>        | N = not foreseen                     |
| <b>Fixing</b>                     | M = fixing screws for metal          |
| <b>Options</b>                    | 00 = none                            |
| <b>Electrical connection</b>      | 3A = DIN EN 175 301-803-C (8 mm)     |
| <b>Voltage - absorbed power</b>   | C020 = 12 V DC - 2 W                 |