

## Fixed interface plate - Mod. XP

Product code: X-P50

Datasheet creation date: 07/03/2025 15:42

Check the most updated document online [click here](#)

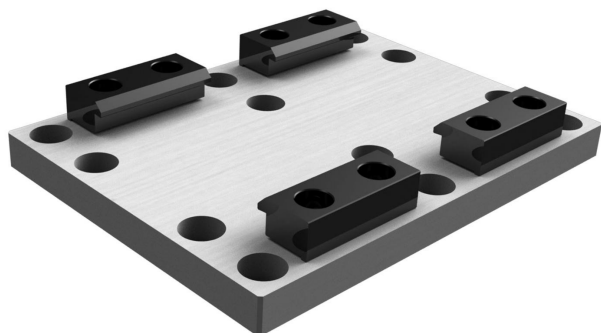

### ■ TECHNICAL DATA

Mod.	X-P50
Size (mm)	50

## Fixed interface plate - Mod. XP

Product code: X-P50

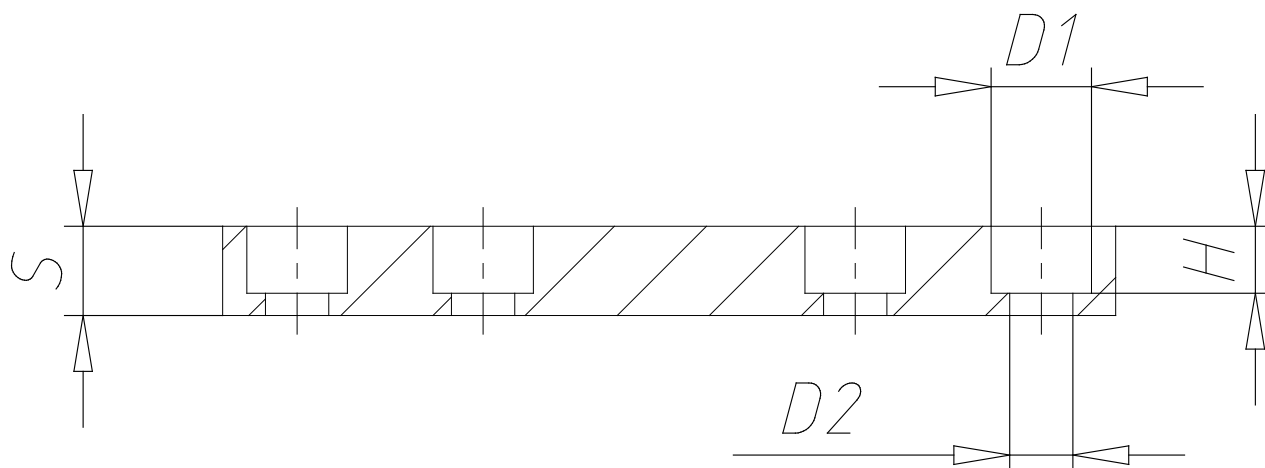

### DIMENSIONS

<b>A1 (mm)</b>	95
<b>A2 (mm)</b>	140
<b>D1 (mm)</b>	9.0
<b>D2 (mm)</b>	5.5
<b>H (mm)</b>	6
<b>L1 (mm)</b>	45
<b>L2 (mm)</b>	80
<b>S (mm)</b>	8
<b>Weight (g)</b>	275