

Mod. X2600 - Series X2000 fittings

Product code: X2600 10-3/8

Datasheet creation date: 10/03/2025 02:56

Check the most updated document online [click here](#)



TECHNICAL DATA

Mod.	X2600 10-3/8
------	--------------

Mod. X2600 - Series X2000 fittings

Product code: X2600 10-3/8

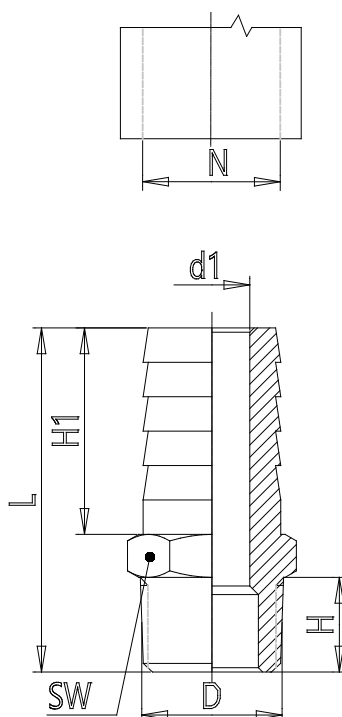

DIMENSIONS

D	R3/8
d (mm)	7.4
H (mm)	11.5
H1 (mm)	19.0
N (mm)	10
L (mm)	36
SW (mm)	17