

Mod. X6432 - Series X6000 fittings

Product code: X6432 10-3/8

Datasheet creation date: 10/03/2025 09:19

Check the most updated document online [click here](#)



TECHNICAL DATA

Mod.	X6432 10-3/8
------	--------------

Mod. X6432 - Series X6000 fittings

Product code: X6432 10-3/8

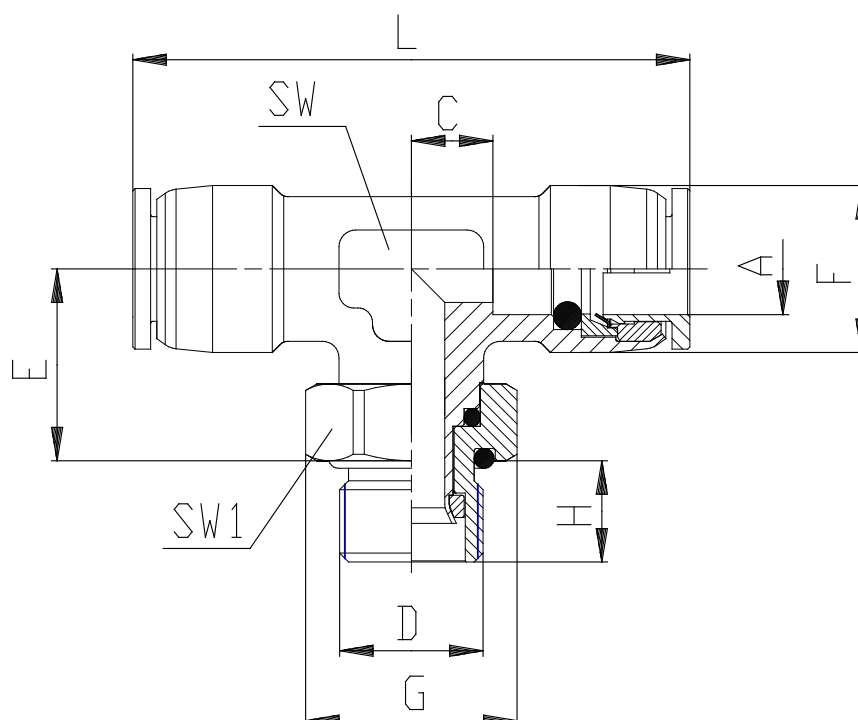

DIMENSIONS

A (mm)	10
C (mm)	10.6
D	G3/8
E (mm)	19.9
F (mm)	17.4
H (mm)	9.0
L (mm)	55.0
SW (mm)	17
SW1 (mm)	22
Weight (g)	91
package	10