

## Mod. X6432 - Series X6000 fittings

Product code: X6432 12-3/8

Datasheet creation date: 10/03/2025 09:19

Check the most updated document online [click here](#)



### TECHNICAL DATA

Mod.	X6432 12-3/8
------	--------------

## Mod. X6432 - Series X6000 fittings

Product code: X6432 12-3/8

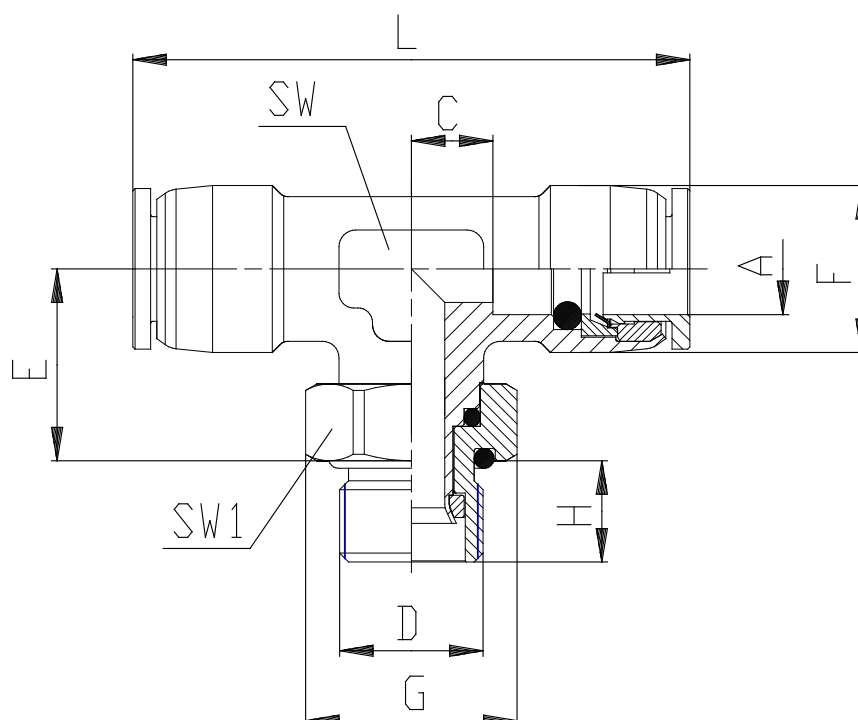

### DIMENSIONS

<b>A (mm)</b>	12
<b>C (mm)</b>	14.0
<b>D</b>	G3/8
<b>E (mm)</b>	22.0
<b>F (mm)</b>	20.0
<b>H (mm)</b>	9.0
<b>L (mm)</b>	58.0
<b>SW (mm)</b>	18
<b>SW1 (mm)</b>	22
<b>Weight (g)</b>	94
<b>package</b>	10